

打造顶级电机制造供应商

Build a top tier motor manufacturing supplier

PRODUCTS CAN BE CUSTOMIZED ACCORDING
TO CUSTOMER REQUIREMENTS

可按照客户的要求定制产品



江苏梦阳电机制造有限公司
JIANGSU MENGYANG MOTOR MANUFACTURE CO., LTD

电话 TEL 0514-80337999 网址 URL www.mengyanggroup.com

邮箱 E-MAIL info@mengyanggroup.com 邮编 ZIP CODE 225800

地址 ADD 中国江苏省宝应经济开发区金源路188号
No. 188 Jinyuan Road, Baoying Economic Development Zone, Jiangsu Province, China

无锡梦元电机制造有限公司
WUXI MENGYUAN MOTOR MANUFACTURE CO., LTD

电话 TEL 0510-85589319 网址 URL www.mengyanggroup.com

邮箱 E-MAIL info@mengyanggroup.com 邮编 ZIP CODE 214000

地址 ADD 中国江苏省无锡市滨湖区胡埭镇龙胆路28号
NO.28 Longdan Road, Binhu District, Wuxi City, Jiangsu Province, China



江苏梦阳电机制造有限公司
Jiangsu Mengyang Motor Manufacture Co., LTD



立足品质、用户至上, 服务为本
Based on quality, customer first, service-oriented

COMPANY PROFILE

企业简介

梦阳电机集团在直流电机、交流电机、无刷电机等电机行业领域方面，是公认的行业领导者，拥有全系列的直流电机、交流电机的产品线。

并致力于打造顶级电机制造供应商。产品远销国内外多个国家和地区，应用范围十分广泛，为汽车行业、智能物流行业、工程机械行业、医疗辅助行业、等客户带来更加高效、便捷的产品与服务，赢得良好的业界口碑。

此外还按照客户的要求定制产品，并获得客户一致好评。

Meng Yang Motors Group is a recognized industry leader in the field of DC motors, AC motors, brushless motors and other motors, with a full range of DC motors and AC motors in its product line.

We are committed to building the top motor manufacturing supplier. Our products are exported to many countries and regions at home and abroad, with a wide range of applications, bringing more efficient and convenient products and services to customers in the automotive industry, intelligent logistics industry, engineering machinery industry, medical assistance industry, and so on, and winning a good reputation in the industry.

In addition, we also customise products according to customers' requirements, and have received unanimous praise from customers.

有关此类电机的某些定制信息，请参见下文。

For information on some of the customisation of these motors, please see below.

设计定制 Design Customization		
温控器设置 Thermal Protection	连续或间歇工作制的特性 Continuous or Intermittent Duty	电压 12V/24V/48V 12V/24V/48VDC
IP 防护等级 IP Protection Designations	低噪音设计 Low Noise Designs	外壳喷漆设计 Painted Cover design
定制轴 Customised Shafts	绝缘电阻设计 Insulation Resistance Design	转子配置 Rotor Configuration
换向器系统设置 Commutator Systems	碳刷寿命设计 Carbon Brush Life Design	单向和双向 Uni-Directional and Bi-Directional
串励式 / 复励式 / 永磁式 Series/ Compound/ Permanent Magnet	可更换碳刷选项 Replaceable Brushes Optionat	安装定制解决方案 Custom Mounting Solutions





PRODUCT CATALOG

产品目录

01

■ 直流有刷电机 DC Brushed Motor

3"A系列电机	3"A Family Motor	1
3"C系列电机	3"C Family Motor	2
3"AA系列电机	3"AA Family Motor	3
3"AB系列电机	3"AB Family Motor	4
3"HT系列电机	3"HT Family Motor	5
4.5"HT系列电机	4.5"HT Family Motor	6
4.5"HP系列电机	4.5"HP Family Motor	7
4.5"E系列电机	4.5"E Family Motor	8
4.5"H系列电机	4.5"H Family Motor	9
4.5"V系列电机	4.5"V Family Motor	10
5"BL系列电机	5"BL Family Motor	11
5"BY系列电机	5"BY Family Motor	12
5"BS系列电机	5"BS Family Motor	13
5.5"AF系列电机	5.5"AF Family Motor	14
6"CE系列电机	6"CE Family Motor	15
7.5"LG系列电机	7.5"LG Family Motor	16
10"ZL系列电机	10"ZL Family Motor	17
清扫车类刷盘电机	"Sweeper Family Brush disc motor	18

02

■ 直流无刷电机 DC Brushless Motor

一体机	19
Controller Integrated Motor	

03

■ 继电器-开关系列 Solenoid-Switch Family

ZJWP/CZ1/ARD1353	20
------------------	----

04

■ 三相感应电动机 Three Phase Induction Motor

AC仓储车驱动电机	Storage Truck Drive Motor	21
转向电机	Steering Motor	22
AC平衡重驱动电机	Counter Balance Drive Motor	23
AC平衡重泵电机	Counter Balance Pump Motor	24

05

■ 交流异步电动机 AC Asynchronous Motor

CDBD-普通铝壳电机B34	Aluminium-Cased Motor B34	25
CEBE-普通铝壳电机B35	Aluminium-Cased Motor B35	26
EHBD-高效IE3铝壳电机B34	IE3 Aluminium-Cased Motor B34	27
EIBE-高效IE3铝壳电机B35	IE3 Aluminium-Cased Motor B35	28
CBBD-液压动力单元电机	Hydraulic Power-Pack Motor	29
CLBD-举升机电机	Car Lift Motor	30
CBAB-登车桥三相电机	Three Phase Dock Leveller Motor	31
CCAB-登车桥三相电机轴承外露式	Three Phase Dock Leveller-Exposed Bearing Motor	32
CBAB-登车桥单相电机	Single-Phase Dock Leveller Motor	33
AJAB-油浸式电机A款	Sub-Oil Motor	34
AKAB-油浸式电机B款	Sub-Oil Motor	35
FBBB-电动液压推杆电动机	Electro-Hydraulic Actuator Motor	36



MengYang Motors Typical Applications

电机典型应用领域



高空作业平台 Aerial Work Platform



农用机械 Agricultural Machinery



电动叉车 Electric Forklift Truck



智能化生产线 Automatic Production Line



车床 Lathe



起重车 Crane Lorry



风力发电机 Wind Turbine



医疗床 Medical Bed



起锚机 Marine Winless



绞盘 Winches



装载机 Excavator



家用电器 Domestic Electric Appliance



轮椅升降 Passenger Lift



展翼车 Wind Body



卡车尾板 Tailgate



MENGYANG GROUP

Enterprise Equipment
企业设备



CERTIFICATE 企业证书

COOPERATIVE ENTERPRISE 合作企业 (排名不分先后)



DC BRUSHED MOTOR

直流有刷电机

3"A系列电机

3"A Family Motor



电机图纸

Motor drawings

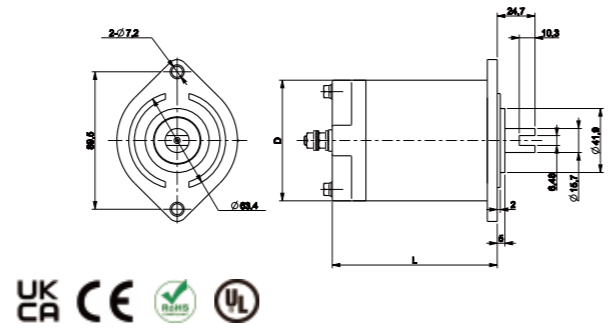

电机参数 Motor Data		电机型号 Motor Model													
		ZD087	ZD089	ZD071	ZD007	ZD075	ZD088	ZD090	ZD072	ZD008	ZD076	ZD066	ZD067	ZD112	ZD102
额定功率 Nominal Power	kW	0.15	0.3	0.5	0.8	0.8	0.15	0.3	0.5	0.8	0.8	0.15	0.3	0.5	0.8
额定电压 Nominal Voltage	V	12	12	12	12	12	24	24	24	24	24	48	48	48	48
环境温度 Environmental Temperature	°C	-20~40°C	-20~40°C	-20~40°C	-20~40°C	-20~40°C	-20~40°C	-20~40°C	-20~40°C	-20~40°C	-20~40°C	-20~40°C	-20~40°C	-20~40°C	-20~40°C
空载转速 No-load Speed	Rpm	2500	2500	4200	4200	4600	2500	2500	4200	4600	4600	3200	2800	3600	4600
空载电流 No-load Current	A	2	5	10	12	14	1.2	2	6	5	5	1.2	1	2	2.5
额定负载 Nominal Torque	N.m	1.2	1.6	2	2	2	0.8	1.6	2	2	2	0.8	1.6	2	2
额定转速 Nominal Speed	Rpm	1200	1800	2300	3100	3400	1650	1800	2400	3100	3400	1650	1800	2500	3100
额定电流 Nominal Current	A	25	40	72	85	90	10	20	36	42	50	5	10	16	23
工作制 Duty Cycle	S2	20MIN	9MIN	2.5MIN	2.5MIN	2MIN	20MIN	3MIN	2.5MIN	2.5MIN	2MIN	6MIN	3MIN	3MIN	2.5MIN
	S3	30%ED	18%ED	10%ED	10%ED	10%ED	30%ED	10%ED	10%ED	10%ED	10%ED	20%ED	10%ED	10%ED	10%ED
电机转向 Motor Rotation	CW/CCW	CCW	CCW	CW	CW	CW	CCW	CCW	CW	CW	CW	CCW	CCW	CCW	CW
电机噪音 Motor Noise	dBA/1m	68	68	68	68	68	68	68	68	68	68	68	68	68	68
电机尺寸 Motor Dimension	L(mm)	108	137	137	137	137	108	137	137	137	137	108	137	137	137
	D(mm)	78.5	78.5	78.5	78.5	79	78.5	78.5	78.5	78.5	79	78.5	78.5	78.5	78.5
电机重量 Motor Weight	Kg	2.1	2.6	2.6	2.6	2.6	2.1	2.6	2.6	2.6	2.6	2.1	2.6	2.6	2.6

电机设计 Motor Design

绝缘等级 Insulation Degree	Class	F	F	F	F	F	F	F	F	F	F	F	F	F	F
温控 Thermal Protection	Optional	✓	✓	✓	✓	✓	✓	✓	✓	✓	✓	✓	✓	✓	✓
防水等级 IP Class	Class	IP65	IP65	IP65	IP65	IP65	IP65	IP65	IP65	IP54	IP65	IP65	IP65	IP65	IP54
励磁方式 Excitation	Wound	永磁 PM	永磁 PM	永磁 PM	永磁 PM	永磁 PM	永磁 PM	永磁 PM	永磁 PM	永磁 PM	永磁 PM	永磁 PM	永磁 PM	永磁 PM	永磁 PM
振动 Vibration	mm/S	<1.6	<1.6	<1.6	<1.6	<1.6	<1.6	<1.6	<1.6	<1.6	<1.6	<1.6	<1.6	<1.6	<1.6
绝缘强度 Insulation Resistance	MΩ	>10	>10	>10	>10	>10	>10	>10	>10	>10	>10	>10	>10	>10	>10
电机寿命 Motor Endurance	Hrs	400	400	400	400	400	400	400	400	400	400	400	400	400	400

其他 Other *可更换电机碳刷 Changeable Brushes

DC BRUSHED MOTOR

直流有刷电机

3"C系列电机

3"C Family Motor



电机图纸

Motor drawings

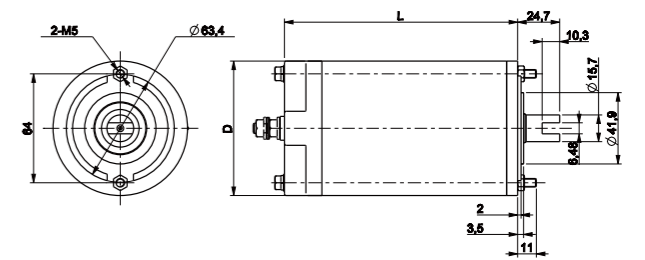

电机参数 Motor Data		电机型号 Motor Model				
		ZD071	ZD075	ZD008	ZD112	ZD102
额定功率 Nominal Power	kW	0.5	0.8	0.8	0.5	0.8
额定电压 Nominal Voltage	V	12	12	24	48	48
环境温度 Environmental Temperature	°C	-20~40°C	-20~40°C	-20~40°C	-20~40°C	-20~40°C
空载转速 No-load Speed	Rpm	4200	4800	4600	3600	4600
空载电流 No-load Current	A	10	14	5	2	2.5
额定负载 Nominal Torque	N.m	2	2	2	2	2
额定转速 Nominal Speed	Rpm	2300	3400	3100	2500	3100
额定电流 Nominal Current	A	72	90	42	16	23
工作制 Duty Cycle	S2	2.5MIN	2MIN	2MIN	2MIN	2.5MIN
	S3	10%ED	10%ED	10%ED	10%ED	10%ED
电机转向 Motor Rotation	CW/CCW	CW	CCW	CW	CW	CW
电机噪音 Motor Noise	dBA/1m	68	68	68	68	68
电机尺寸 Motor Dimension	L (mm)	137	137	137	137	137
	D (mm)	79	79	79	79	79
电机重量 Motor Weight	Kg	2.6	2.6	2.6	2.6	2.6

电机设计 Motor Design

绝缘等级 Insulation Degree	Class	F	F	F	F	F
温控 Thermal Protection	Optional	✓	✓	✓	✓	✓
防水等级 IP Class	Class	IP54	IP54	IP54	IP54	IP54
励磁方式 Excitation	Wound	永磁 PM	永磁 PM	永磁 PM	永磁 PM	永磁 PM
振动 Vibration	mm/S	<1.6	<1.6	<1.6	<1.6	<1.6
绝缘强度 Insulation Resistance	MΩ	>10	>10	>10	>10	>10
电机寿命 Motor Endurance	Hrs	400	400	400	400	400

其他 Other *可更换电机碳刷 Changeable Brushes

DC BRUSHED MOTOR

直流有刷电机

3"AA系列电机

3"AA Family Motor



电机图纸

Motor drawings

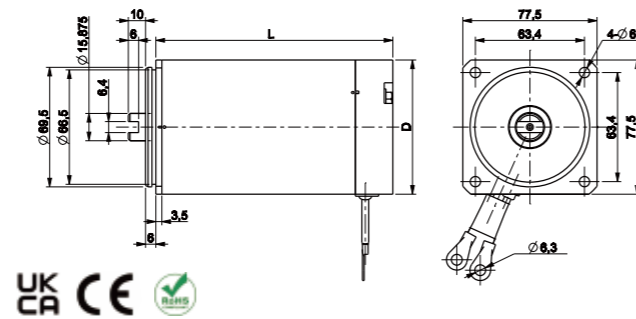

电机参数 Motor Data		电机型号 Motor Model				
		ZD109	ZD059	ZD110	ZD060	ZD111
额定功率 Nominal Power	kW	0.3	0.5	0.3	0.5	0.3
额定电压 Nominal Voltage	V	12	12	24	24	36
环境温度 Environmental Temperature	°C	-20-40°C	-20-40°C	-20-40°C	-20-40°C	-20-40°C
空载转速 No-load Speed	Rpm	4200	3800	3500	4000	4200
空载电流 No-load Current	A	3	7	1.5	4	1
额定负载 Nominal Torque	N.m	1	1.2	1	1.2	1.4
额定转速 Nominal Speed	Rpm	2000	2600	2000	2800	2600
额定电流 Nominal Current	A	42	50	20	25	20
工作制 Duty Cycle	S2	2MIN	5MIN	1.5MIN	10MIN	5MIN
	S3	10%ED	10%ED	10%ED	20%ED	10%ED
电机转向 Motor Rotation	CW/CCW	CW/CCW	CW	CW	CW	CW
电机噪音 Motor Noise	dBA/1m	56	56	56	56	56
电机尺寸 Motor Dimension	L (mm)	122	138	122	138	122
	D (mm)	78	78	78	78	78
电机重量 Motor Weight	Kg	2.1	2.4	2.1	2.4	2.1

电机设计 Motor Design

绝缘等级 Insulation Degree	Class	F	F	F	F	F
温控 Thermal Protection	Optional	✓	✓	✓	✓	✓
防水等级 IP Class	Class	IP67	IP67	IP67	IP67	IP67
励磁方式 Excitation	Wound	永磁 PM	永磁 PM	永磁 PM	永磁 PM	永磁 PM
振动 Vibration	mm/S	<1.3	<1.3	<1.3	<1.3	<1.3
绝缘强度 Insulation Resistance	MΩ	>10	>10	>10	>10	>10
电机寿命 Motor Endurance	Hrs	400	400	400	400	400

其他 Other

DC BRUSHED MOTOR

直流有刷电机

3"AB系列电机

3"AB Family Motor



电机图纸

Motor drawings

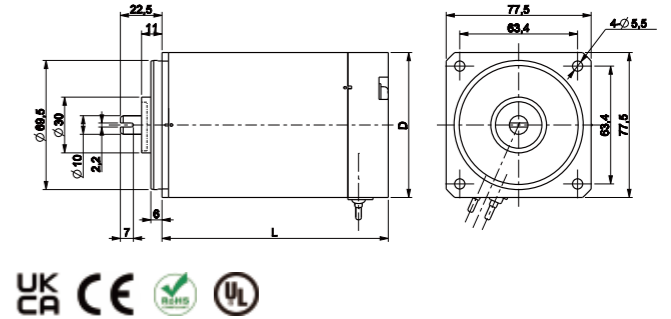

电机参数 Motor Data		电机型号 Motor Model		
		ZD094B	ZD106	ZD095
额定功率 Nominal Power	kW	0.3	0.35	0.3
额定电压 Nominal Voltage	V	24	24	24
环境温度 Environmental Temperature	°C	-20-40°C	-20-40°C	-20-40°C
空载转速 No-load Speed	Rpm	5000	4100	5000
空载电流 No-load Current	A	2.1	3.0	2.1
额定负载 Nominal Torque	N.m	85	80	85
额定转速 Nominal Speed	Rpm	3400	3500	3600
额定电流 Nominal Current	A	20	22	20
工作制 Duty Cycle	S2	3MIN	3MIN	3MIN
	S3	10%ED	10%ED	10%ED
电机转向 Motor Rotation	CW/CCW	CW	CW	CW
电机噪音 Motor Noise	dBA/1m	56	60	56
电机尺寸 Motor Dimension	L (mm)	165.8	122	122
	D (mm)	78	78	78
电机重量 Motor Weight	Kg	2	1.8	1.8

电机设计 Motor Design

绝缘等级 Insulation Degree	Class	F	F	F
温控 Thermal Protection	Optional	✓	✓	✓
防水等级 IP Class	Class	ZP66	IP66	IP67
励磁方式 Excitation	Wound	永磁 PM	永磁 PM	永磁 PM
振动 Vibration	mm/S	<1.3	<1.3	<1.3
绝缘强度 Insulation Resistance	MΩ	>10	>10	>10
电机寿命 Motor Endurance	Hrs	400	400	400

其他 Other

DC BRUSHED MOTOR

直流有刷电机

3"HT系列电机

3"HT Family Motor



电机图纸

Motor drawings

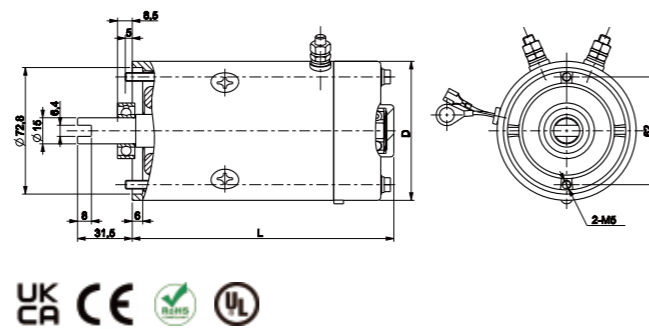

电机参数 Motor Data		电机型号 Motor Model			
		ZD023	ZD026	ZD024	ZD027
额定功率 Nominal Power	kW	0.8	0.8	0.8	1
额定电压 Nominal Voltage	V	12	12	24	24
环境温度 Environmental Temperature	°C	-20-40°C	-20-40°C	-20-40°C	-20-40°C
空载转速 No-load Speed	Rpm	5200	6800	5200	7200
空载电流 No-load Current	A	15	20	8	12
额定负载 Nominal Torque	N.m	2.9	2	2.58	2.5
额定转速 Nominal Speed	Rpm	3300	4200	3300	3800
额定电流 Nominal Current	A	125	108	60	60
工作制 Duty Cycle	S2	1.8MIN	2MIN	1.8MIN	2MIN
	S3	7%ED	8%ED	7%ED	8%ED
电机转向 Motor Rotation	CW/CCW	CW/CCW	CW	CW/CCW	CW
电机噪音 Motor Noise	dBA/1m	68	68	68	68
电机尺寸 Motor Dimension	L (mm)	165.5	150.5	165.5	150.5
	D (mm)	80	80	80	80
电机重量 Motor Weight	Kg	3.6	3.1	3.6	3.1

电机设计 Motor Design

绝缘等级 Insulation Degree	Class	F	F	F	F
温控 Thermal Protection	Optional	✓	✓	✓	✓
防水等级 IP Class	Class	IP54	IP54	IP54	IP54
励磁方式 Excitation	Wound	永磁 PM	复励 Compound	永磁 PM	复励 Compound
振动 Vibration	mm/S	<1.6	<1.6	<1.6	<1.6
绝缘强度 Insulation Resistance	MΩ	>10	>10	>10	>10
电机寿命 Motor Endurance	Hrs	400	400	400	400

其他 Other *可更换电机碳刷 Changeable Brushes

DC BRUSHED MOTOR

直流有刷电机

4.5"HT系列电机

4.5"HT Family Motor



电机图纸

Motor drawings

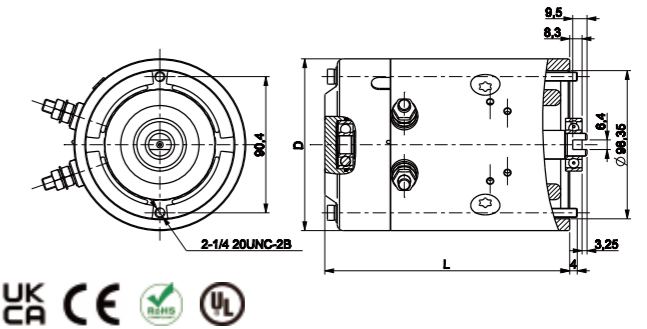

电机参数 Motor Data		电机型号 Motor Model						
		ZD053	ZD048	ZD033	ZD056	ZD035	ZD116	ZD010
额定功率 Nominal Power	kW	1.3	1.6	2	1.3	2.2	2.5	2
额定电压 Nominal Voltage	V	12	12	12	24	24	24	48
环境温度 Environmental Temperature	°C	-20-40°C	-20-40°C	-20-40°C	-20-40°C	-20-40°C	-20-40°C	-20-40°C
空载转速 No-load Speed	Rpm	5500	4200	6200	5500	5500	5500	5000
空载电流 No-load Current	A	35	35	50	20	20	20	10
额定负载 Nominal Torque	N.m	4.7	6	5.4	4.7	6	10	7.5
额定转速 Nominal Speed	Rpm	2400	2650	2586	2400	2800	2500	2700
额定电流 Nominal Current	A	160	185	200	80	110	150	65
工作制 Duty Cycle	S2	1.2MIN	4MIN	7.5MIN	1.2MIN	2MIN	2.5MIN	3MIN
	S3	4.5%ED	8%ED	20%ED	4.5%ED	7.5%ED	10%ED	12%ED
电机转向 Motor Rotation	CW/CCW	CW	CW	CW	CW	CW	CW	CW
电机噪音 Motor Noise	dBA/1m	72	72	72	72	72	72	72
电机尺寸 Motor Dimension	L (mm)	138	162.5	179.5	138	162.5	179.1	162.5
	D (mm)	114	114	114	114	114	114	114
电机重量 Motor Weight	Kg	5.1	7.2	8.2	5.1	6.9	8.2	6.9

电机设计 Motor Design

绝缘等级 Insulation Degree	Class	F	F	F	F	F	F	F
温控 Thermal Protection	Optional	✓	✓	✓	✓	✓	✓	✓
防水等级 IP Class	Class	IP54	IP54	IP54	IP54	IP54	IP54	IP54
励磁方式 Excitation	Wound	串励 Series	复励 Compound	串励 Series	串励 Series	复励 Compound	复励 Compound	复励 Compound
振动 Vibration	mm/S	<2	<2	<2	<2	<2	<2	<2
绝缘强度 Insulation Resistance	MΩ	>10	>10	>10	>10	>10	>10	>10
电机寿命 Motor Endurance	Hrs	400	400	400	400	400	400	400

其他 Other *可更换电机碳刷 Changeable Brushes

DC BRUSHED MOTOR

直流有刷电机

4.5"HP系列电机

4.5"HP Family Motor



电机图纸

Motor drawings

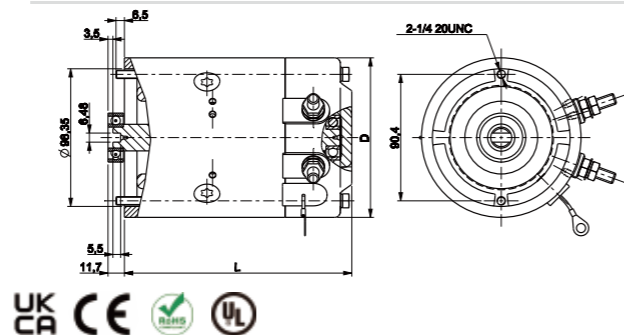

电机参数 Motor Data		电机型号 Motor Model					
		ZD036	ZD034	ZD033	ZD054	ZD035	ZD010
额定功率 Nominal Power	kW	1.6	2	2.5	1.2	2.2	2.2
额定电压 Nominal Voltage	V	12	12	12	24	24	48
环境温度 Environmental Temperature	°C	-20-40°C	-20-40°C	-20-40°C	-20-40°C	-20-40°C	-20-40°C
空载转速 No-load Speed	Rpm	6200	3800	6200	6000	5500	4800
空载电流 No-load Current	A	45	40	50	20	20	15
额定负载 Nominal Torque	N.m	6	8	10	3	8	8
额定转速 Nominal Speed	Rpm	2800	2400	2400	4500	2800	2600
额定电流 Nominal Current	A	210	220	265	85	135	75
工作制 Duty Cycle	S2	3MIN	2MIN	2.5MIN	1.2MIN	2MIN	3.5MIN
	S3	10%ED	8%ED	10%ED	4.5%ED	8%ED	15%ED
电机转向 Motor Rotation	CW/CCW	CCW	CCW	CCW	CCW	CCW	CCW
电机噪音 Motor Noise	dBA/1m	72	72	72	72	72	72
电机尺寸 Motor Dimension	L (mm)	162.5	162.5	179.5	138	162.5	162.5
	D (mm)	114	114	114	114	114	114
电机重量 Motor Weight	Kg	6.7	6.9	8.2	5.1	6.9	6.9

电机设计 Motor Design

绝缘等级 Insulation Degree	Class	F	F	F	F	F	F
温控 Thermal Protection	Optional	✓	✓	✓	✓	✓	✓
防水等级 IP Class	Class	IP54	IP54	IP54	IP54	IP54	IP54
励磁方式 Excitation	Wound	串励 Series	复励 Compound	串励 Series	复励 Compound	复励 Compound	复励 Compound
振动 Vibration	mm/S	<2	<2	<2	<2	<2	<2
绝缘强度 Insulation Resistance	MΩ	>10	>10	>10	>10	>10	>10
电机寿命 Motor Endurance	Hrs	400	400	800	400	400	400

其他 Other *可更换电机碳刷 Changeable Brushes

DC BRUSHED MOTOR

直流有刷电机

4.5"E系列电机

4.5"E Family Motor



电机图纸

Motor drawings

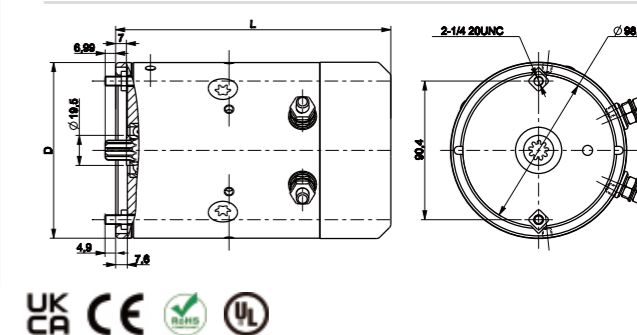

电机参数 Motor Data		电机型号 Motor Model									
		ZD028	ZD017	ZD033	ZD042	ZD029A	ZD035	ZD029	ZD085	ZD010	ZD132
额定功率 Nominal Power	kW	1.6	1.8	2.2	2.2	2.2	2.2	2.5	2.8	2.0	3.0
额定电压 Nominal Voltage	V	12	12	12	24	24	24	24	24	48	48
环境温度 Environmental Temperature	°C	-20-40°C	-20-40°C	-20-40°C	-20-40°C	-20-40°C	-20-40°C	-20-40°C	-20-40°C	-20-40°C	-20-40°C
空载转速 No-load Speed	Rpm	5200	7000	6200	4000	7000	6200	7000	8200	4800	5200
空载电流 No-load Current	A	45	50	50	20	25	25	25	25	15	20
额定负载 Nominal Torque	N.m	6	6	6	8	8	8	10	10	8	9.6
额定转速 Nominal Speed	Rpm	2650	3000	3000	2650	2800	2800	2850	3000	2650	3500
额定电流 Nominal Current	A	200	225	210	125	145	135	175	175	75	105
工作制 Duty Cycle	S2	2MIN	2MIN	8MIN	2MIN	2MIN	2MIN	2MIN	5MIN	2MIN	6MIN
	S3	7%ED	7%ED	20%ED	7%ED	8%ED	7%ED	8%ED	13%ED	7%ED	10%ED
电机转向 Motor Rotation	CW/CCW	CW	CW	CW	CW	CW	CW	CW	CW	CW	CW
电机噪音 Motor Noise	dBA/1m	72	72	72	72	72	72	72	72	72	72
电机尺寸 Motor Dimension	L(mm)	179	179	189.5	171.7	178.6	175.6	179	204	179	213.7
	D(mm)	114	114	114	114	114	114	114	114	114	114
电机重量 Motor Weight	Kg	7.0	7.0	8.2	7.2	7.2	7.2	7.2	9.4	7.0	9.4

电机设计 Motor Design

绝缘等级 Insulation Degree	Class	F	F	F	F	F	F	F	F	F	F
温控 Thermal Protection	Optional	✓	✓	✓	✓	✓	✓	✓	✓	✓	✓
防水等级 IP Class	Class	IP54	IP54	IP54	IP54	IP65	IP54	IP54	IP54	IP54	IP23
励磁方式 Excitation	Wound	复励 Compound	串励 Series	串励 Series	复励 Compound	复励 Compound	复励 Compound	复励 Compound	串励 Series	复励 Compound	复励 Compound
振动 Vibration	mm/S	<2	<2	<2	<2	<2	<2	<2	<2	<2	<2
绝缘强度 Insulation Resistance	MΩ	>10	>10	>10	>10	>10	>10	>10	>10	>10	>10
电机寿命 Motor Endurance	Hrs	400	400	800	400	400	400	400	800	400	400

其他 Other *可更换电机碳刷 Changeable Brushes

DC BRUSHED MOTOR

直流有刷电机

4.5"H系列电机

4.5" H Family Motor



电机图纸

Motor drawings

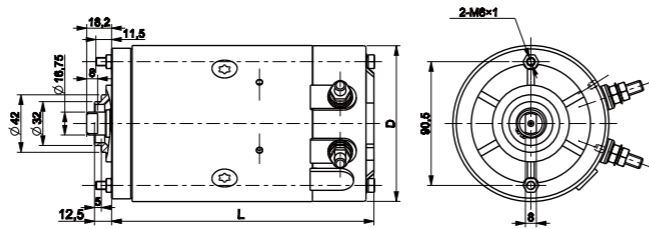

电机参数 Motor Data		电机型号 Motor Model								
		ZD053	ZD036	ZD034	ZD033	ZD054	ZD035	ZD085	ZD010	ZD132
额定功率 Nominal Power	kW	1.2	1.6	2	2	1.2	2.2	2.8	2	3
额定电压 Nominal Voltage	V	12	12	12	12	24	24	24	48	48
环境温度 Environmental Temperature	°C	-20-40°C	-20-40°C	-20-40°C	-20-40°C	-20-40°C	-20-40°C	-20-40°C	-20-40°C	-20-40°C
空载转速 No-load Speed	Rpm	5500	6200	3800	6200	6000	5500	8200	4800	5200
空载电流 No-load Current	A	35	45	40	50	20	20	25	15	20
额定负载 Nominal Torque	N.m	4.7	6	8	5.4	3	7.5	10	7	8
额定转速 Nominal Speed	Rpm	2400	2650	2300	2586	4500	2600	3000	2850	3800
额定电流 Nominal Current	A	160	200	210	200	85	125	175	70	95
工作制 Duty Cycle	S2	1.2MIN	2MIN	2MIN	7.5MIN	1.2MIN	2MIN	5MIN	2MIN	6MIN
	S3	4.5%ED	5%ED	8%ED	20%ED	4.5%ED	5%ED	13%ED	8%ED	10%ED
电机转向 Motor Rotation	CW/CCW	CW	CW	CW	CW	CW	CW	CW	CW	CW
电机噪音 Motor Noise	dB(A)/1m	72	72	72	72	72	72	72	72	72
电机尺寸 Motor Dimension	L(mm)	153	174.3	174.3	191.3	153	174.3	206.1	177.5	218.1
	D(mm)	114	114	114	114	114	114	114	114	114
电机重量 Motor Weight	Kg	5.1	7.1	7.6	8.2	5.1	7.1	9.4	7.5	9.4

电机设计 Motor Design

绝缘等级 Insulation Degree	Class	F	F	F	F	F	F	F	F	F
温控 Thermal Protection	Optional	✓	✓	✓	✓	✓	✓	✓	✓	✓
防水等级 IP Class	Class	IP54	IP54	IP54	IP54	IP54	IP54	IP54	IP54	IP54
励磁方式 Excitation	Wound	串励 Series	串励 Series	复励 Compound	串励 Series	复励 Compound	复励 Compound	串励 Series	复励 Compound	复励 Compound
振动 Vibration	mm/S	<2	<2	<2	<2	<2	<2	<2	<2	<2
绝缘强度 Insulation Resistance	MΩ	>10	>10	>10	>10	>10	>10	>10	>10	>10
电机寿命 Motor Endurance	Hrs	400	400	400	800	400	400	800	400	400

其他 Other *可更换电机碳刷 Changeable Brushes

DC BRUSHED MOTOR

直流有刷电机

4.5"V系列电机

4.5" V Family Motor



电机图纸

Motor drawings

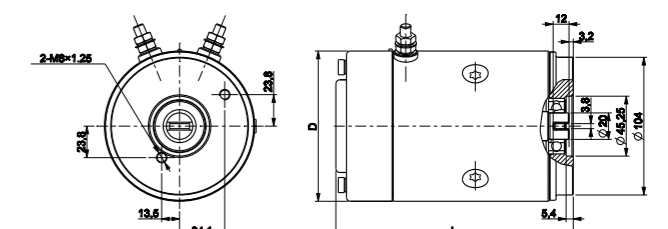

电机参数 Motor Data		电机型号 Motor Model									
		ZD048	ZD064	ZD025	ZD010	ZD012	ZD096	ZD033	ZD021	ZD085	ZD086
额定功率 Nominal Power	kW	1.6	2	2.5	2	2	2.2	2.5	2.5	2.8	3
额定电压 Nominal Voltage	V	12	12	24	48	72	24	12	24	24	24
环境温度 Environmental Temperature	°C	-20-40°C	-20-40°C	-20-40°C	-20-40°C	-20-40°C	-20-40°C	-20-40°C	-20-40°C	-20-40°C	-20-40°C
空载转速 No-load Speed	Rpm	4200	5800	6200	4800	5800	6200	6200	6200	8000	4200
空载电流 No-load Current	A	35	40	20	12	10	20	50	35	40	20
额定负载 Nominal Torque	N.m	6	8	10	7	7	10	10	10	9	11
额定转速 Nominal Speed	Rpm	2650	2600	2650	2850	3200	2250	2400	2950	3100	2850
额定电流 Nominal Current	A	185	265	135	70	50	135	280	170	170	170
工作制 Duty Cycle	S2	2Min	2Min	2Min	2Min	2Min	2Min	5Min	2Min	5Min	4Min
	S3	8%ED	8%ED	8%ED	8%ED	8%ED	8%ED	13%ED	8%ED	13%ED	15%ED
电机转向 Motor Rotation	CW/CCW	CW	CW	CW	CW	CW	CW	CW	CW	CW	CW
电机噪音 Motor Noise	dB(A)/1m	72	72	72	72	72	72	72	72	72	82
电机尺寸 Motor Dimension	L(mm)	178.8	178.8	178.8	178.8	178.8	209.8	195.8	178.8	220.6	229
	D(mm)	114	114	114	114	114	114	114	114	114	127
电机重量 Motor Weight	Kg	6.9	6.9	6.9	6.9	6.9	9	8.4	6.9	9.4	12

电机设计 Motor Design

绝缘等级 Insulation Degree	Class	F	F	F	F	F	F	F	F	F	F
温控 Thermal Protection	Optional	✓	✓	✓	✓	✓	✓	✓	✓	✓	✓
防水等级 IP Class	Class	IP54	IP54	IP54	IP54	IP54	IP54	IP54	IP54	IP54	IP23
励磁方式 Excitation	Wound	复励 Compound	复励 Compound	复励 Compound	复励 Compound	复励 Compound	复励 Compound	串励 Series	复励 Compound	串励 Series	复励 Compound
振动 Vibration	mm/S	<2	<2	<2	<2	<2	<2	<2	<2	<2	<3.8
绝缘强度 Insulation Resistance	MΩ	>10	>10	>10	>10	>10	>10	>10	>10	>10	>10
电机寿命 Motor Endurance	Hrs	400	400	400	400	400	400	800	400	800	800

其他 Other *可更换电机碳刷 Changeable Brushes

DC BRUSHED MOTOR

直流有刷电机

5"BL系列电机

5" BL Family Motor



• 电机图纸

Motor drawings

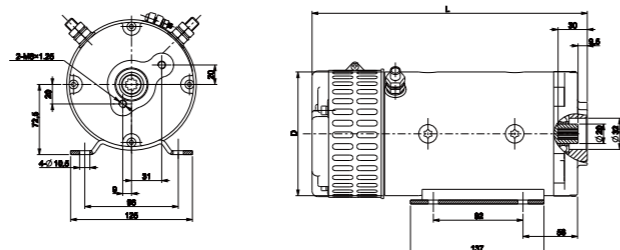

电机参数 Motor Data		电机型号 Motor Model	
		ZD002	ZD061
额定功率 Nominal Power	kW	4.5	4
额定电压 Nominal Voltage	V	24	48
环境温度 Environmental Temperature	°C	-20-40°C	-20-40°C
空载转速 No-load Speed	Rpm	7200	6800
空载电流 No-load Current	A	45	20
额定负载 Nominal Torque	N.m	14	14
额定转速 Nominal Speed	Rpm	2800	2800
额定电流 Nominal Current	A	210	110
工作制 Duty Cycle	S2	12MIN	6MIN
	S3	20%ED	12%ED
电机转向 Motor Rotation	CW/CCW	CW	CW
电机噪音 Motor Noise	dBA/1m	90	90
电机尺寸 Motor Dimension	L (mm)	282.5	282.5
	D (mm)	127	127
电机重量 Motor Weight	Kg	15.5	15.5

电机设计 Motor Design

绝缘等级 Insulation Degree	Class	H	H
温控 Thermal Protection	Optional	✓	✓
防水等级 IP Class	Class	IP23	IP23
励磁方式 Excitation	Wound	串励 Series	串励 Series
振动 Vibration	mm/S	<5	<5
绝缘强度 Insulation Resistance	MΩ	>20	>20
电机寿命 Motor Endurance	Hrs	800	800

其他 Other *可更换电机碳刷 Changeable Brushes

DC BRUSHED MOTOR

直流有刷电机

5"BY系列电机

5" BY Family Motor



• 电机图纸

Motor drawings

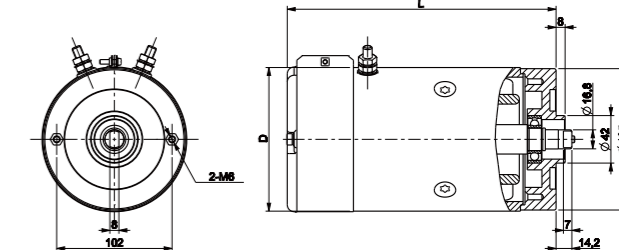

电机参数 Motor Data		电机型号 Motor Model		
		ZD084	ZD086	ZD062
额定功率 Nominal Power	kW	3.2KW	3KW	3.2KW
额定电压 Nominal Voltage	V	24V	24V	48V
环境温度 Environmental Temperature	°C	-20-40°C	-20-40°C	-20-40°C
空载转速 No-load Speed	Rpm	7600	4200	6800
空载电流 No-load Current	A	35	20	20
额定负载 Nominal Torque	N.m	9.7	10	9.7
额定转速 Nominal Speed	Rpm	3250	2850	3150
额定电流 Nominal Current	A	175	165	90
工作制 Duty Cycle	S2	5MIN	5MIN	5MIN
	S3	16%ED	9%ED	16%ED
电机转向 Motor Rotation	CW/CCW	CW	CW	CW
电机噪音 Motor Noise	dBA/1m	82	82	82
电机尺寸 Motor Dimension	L (mm)	237.5	237.5	237.5
	D (mm)	127	127	127
电机重量 Motor Weight	Kg	12	12	12

电机设计 Motor Design

绝缘等级 Insulation Degree	Class	F	F	F
温控 Thermal Protection	Optional	✓	✓	✓
防水等级 IP Class	Class	IP21	IP54	IP21
励磁方式 Excitation	Wound	串励 Series	复励 Compound	串励 Series
振动 Vibration	mm/S	<3.8	<3.8	<3.8
绝缘强度 Insulation Resistance	MΩ	>10	>10	>10
电机寿命 Motor Endurance	Hrs	800	800	800

其他 Other *可更换电机碳刷 Changeable Brushes

DC BRUSHED MOTOR

直流有刷电机

5"BS系列电机

5"BS Family Motor



电机图纸

Motor drawings

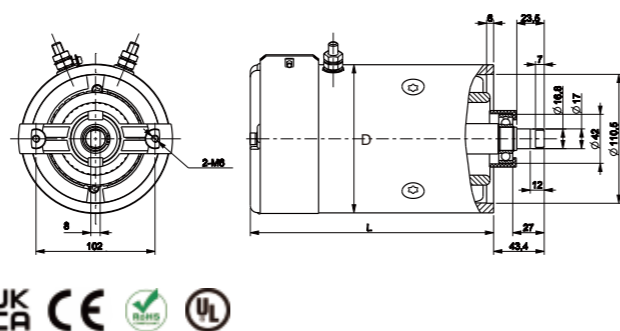

电机参数 Motor Data		电机型号 Motor Model			
		ZD084	ZD062	ZD084	ZD086
额定功率 Nominal Power	kW	3.2	3.2	3	3
额定电压 Nominal Voltage	V	24	48	24	24
环境温度 Environmental Temperature	°C	-20-40°C	-20-40°C	-20-40°C	-20-40°C
空载转速 No-load Speed	Rpm	7600	6800	6500	4200
空载电流 No-load Current	A	35	20	25	20
额定负载 Nominal Torque	N.m	9.7	9.7	10	10
额定转速 Nominal Speed	Rpm	3250	3250	3000	2850
额定电流 Nominal Current	A	175	95	165	165
工作制 Duty Cycle	S2	5MIN	5MIN	6MIN	5MIN
	S3	16%ED	16%ED	11%ED	9%ED
电机转向 Motor Rotation	CW/CCW	CCW	CW	CW	CW
电机噪音 Motor Noise	dB(A)/1m	82	82	82	82
电机尺寸 Motor Dimension	L (mm)	225	223.8	208.5	208.5
	D (mm)	125	127	127	127
电机重量 Motor Weight	Kg	12	12	12	12

电机设计 Motor Design

绝缘等级 Insulation Degree	Class	F	F	F	F
温控 Thermal Protection	Optional	✓	✓	✓	✓
防水等级 IP Class	Class	IP21	IP21	IP21	IP21
励磁方式 Excitation	Wound	串励 Series	串励 Series	串励 Series	复励 Compound
振动 Vibration	mm/S	<3.8	<3.8	<3.8	<3.8
绝缘强度 Insulation Resistance	MΩ	>10	>10	>10	>10
电机寿命 Motor Endurance	Hrs	800	800	800	800

其他 Other *可更换电机碳刷 Changeable Brushes

DC BRUSHED MOTOR

直流有刷电机

5.5"AF系列电机

5.5"AF Family Motor



电机图纸

Motor drawings

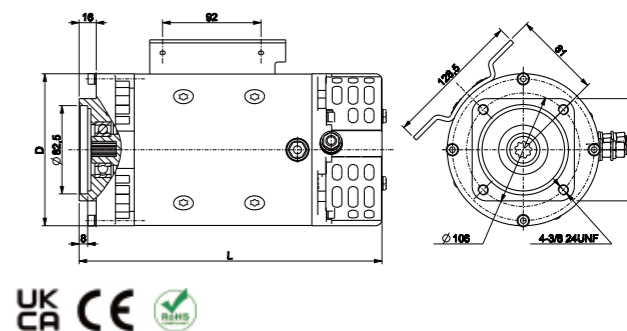

电机参数 Motor Data		电机型号 Motor Model		
		ZD100	ZD101	ZD065
额定功率 Nominal Power	kW	3.3	4.5	4.5
额定电压 Nominal Voltage	V	24	24	48
环境温度 Environmental Temperature	°C	-20-40°C	-20-40°C	-20-40°C
空载转速 No-load Speed	Rpm	6800	7000	6800
空载电流 No-load Current	A	35	40	20
额定负载 Nominal Torque	N.m	10	17	17
额定转速 Nominal Speed	Rpm	2900	2550	2550
额定电流 Nominal Current	A	160	240	110
工作制 Duty Cycle	S2	20MIN	15MIN	15MIN
	S3	35%ED	30%ED	30%ED
电机转向 Motor Rotation	CW/CCW	CCW	CW	CW
电机噪音 Motor Noise	dB(A)/1m	90	90	90
电机尺寸 Motor Dimension	L (mm)	283	283	283
	D (mm)	142	142	142
电机重量 Motor Weight	Kg	19.5	16.8	16.8

电机设计 Motor Design

绝缘等级 Insulation Degree	Class	H	H	H
温控 Thermal Protection	Optional	✓	✓	✓
防水等级 IP Class	Class	IP23	IP23	IP23
励磁方式 Excitation	Wound	串励 Series	串励 Series	串励 Series
振动 Vibration	mm/S	<5	<5	<5
绝缘强度 Insulation Resistance	MΩ	>10	>10	>10
电机寿命 Motor Endurance	Hrs	800	800	800

其他 Other *可更换电机碳刷 Changeable Brushes

DC BRUSHED MOTOR

直流有刷电机

6"CE系列电机

6"CE Family Motor



• 电机图纸

Motor drawings

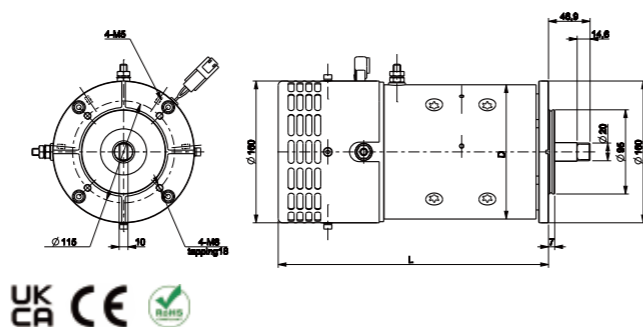

电机参数 Motor Data		电机型号 Motor Model	
		ZD144	ZD145
额定功率 Nominal Power	kW	4.5	3
额定电压 Nominal Voltage	V	24	48
环境温度 Environmental Temperature	°C	-20-40°C	-20-40°C
空载转速 No-load Speed	Rpm	7000	4500
空载电流 No-load Current	A	50	35
额定负载 Nominal Torque	N.m	20	7.3
额定转速 Nominal Speed	Rpm	2000	3900
额定电流 Nominal Current	A	265	85
工作制 Duty Cycle	S2	4.5MIN	10MIN
	S3	12%ED	20%ED
电机转向 Motor Rotation	CW/CCW	CW	CW
电机噪音 Motor Noise	dB(A)/1m	82	90
电机尺寸 Motor Dimension	L (mm)	311	305
	D (mm)	151.5	151.5
电机重量 Motor Weight	Kg	17.5	17.5

电机设计 Motor Design

绝缘等级 Insulation Degree	Class	F	F
温控 Thermal Protection	Optional	✓	✓
防水等级 IP Class	Class	IP21	IP21
励磁方式 Excitation	Wound	串励 Series	串励 Series
振动 Vibration	mm/S	<5	<5
绝缘强度 Insulation Resistance	MΩ	>10	>10
电机寿命 Motor Endurance	Hrs	800	800

其他 Other *可更换电机碳刷 Changeable Brushes

DC BRUSHED MOTOR

直流有刷电机

7.5"LG系列电机

7.5"LG Family Motor



• 电机图纸

Motor drawings

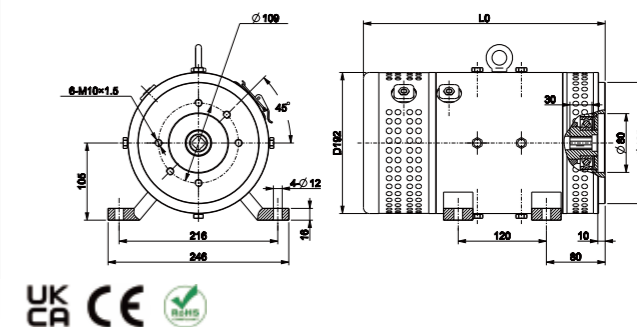

电机参数 Motor Data		电机型号 Motor Model		
		LC054	LC068	LC049
额定功率 Nominal Power	kW	5.5	7.5	5.5
额定电压 Nominal Voltage	V	24	24	48
环境温度 Environmental Temperature	°C	-20-40°C	-20-40°C	-20-40°C
空载转速 No-load Speed	Rpm	5000	6500	5500
空载电流 No-load Current	A	55	85	30
额定负载 Nominal Torque	N.m	25	27	25
额定转速 Nominal Speed	Rpm	1800	2600	2100
额定电流 Nominal Current	A	250	420	150
工作制 Duty Cycle	S2	15MIN	6MIN	15MIN
	S3	25%ED	15%ED	25%ED
电机转向 Motor Rotation	CW/CCW	CCW	CCW	CCW
电机噪音 Motor Noise	dB(A)/1m	90	82	90
电机尺寸 Motor Dimension	L (mm)	329	313	329
	D (mm)	192	192	192
电机重量 Motor Weight	Kg	44	36	44

电机设计 Motor Design

绝缘等级 Insulation Degree	Class	H	H	H
温控 Thermal Protection	Optional	✓	✓	✓
防水等级 IP Class	Class	IP20	IP20	IP20
励磁方式 Excitation	Wound	串励 Series	串励 Series	串励 Series
振动 Vibration	mm/S	<5	<5	<5
绝缘强度 Insulation Resistance	MΩ	>20	>20	>20
电机寿命 Motor Endurance	Hrs	800	800	800

其他 Other *可更换电机碳刷 Changeable Brushes

DC BRUSHED MOTOR

直流有刷电机

10"ZL系列电机

10" ZL Family Motor



• 电机图纸

Motor drawings

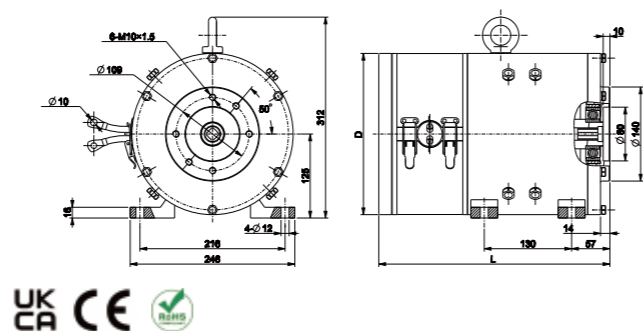

电机参数 Motor Data		电机型号 Motor Model	
		LC063	LC050
额定功率 Nominal Power	kW	7.5	7.5
额定电压 Nominal Voltage	V	24	48
环境温度 Environmental Temperature	°C	-20-40°C	-20-40°C
空载转速 No-load Speed	Rpm	4200	4200
空载电流 No-load Current	A	80	35
额定负载 Nominal Torque	N.m	45	45
额定转速 Nominal Speed	Rpm	1600	1550
额定电流 Nominal Current	A	425	220
工作制 Duty Cycle	S2	15MIN	15MIN
	S3	20%ED	20%ED
电机转向 Motor Rotation	CW/CCW	CCW	CCW
电机噪音 Motor Noise	dBA/1m	82	82
电机尺寸 Motor Dimension	L (mm)	345	345
	D (mm)	240	240
电机重量 Motor Weight	Kg	68	68

电机设计 Motor Design			
绝缘等级 Insulation Degree	Class	H	H
温控 Thermal Protection	Optional	✓	✓
防水等级 IP Class	Class	IP20	IP20
励磁方式 Excitation	Wound	串励 Series	串励 Series
振动 Vibration	mm/S	<5	<5
绝缘强度 Insulation Resistance	MΩ	>20	>20
电机寿命 Motor Endurance	Hrs	800	800

其他 Other *可更换电机碳刷 Changeable Brushes

DC BRUSHED MOTOR

直流有刷电机

清扫车类刷盘电机

Sweeper Family Brush disc motor



• 电机图纸

Motor drawings

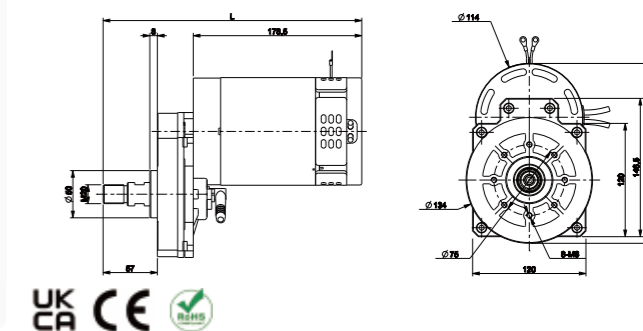

电机参数 Motor Data		电机型号 Motor Model					
		M09	M10	M11	M12	M13	M15
额定功率 Nominal Power	kW	0.4KW	0.4KW	0.55KW	0.55KW	0.55KW	0.55KW
额定电压 Nominal Voltage	V	24V	24V	24V	24V	24V	24V
环境温度 Environmental Temperature	°C	-20-40°C	-20-40°C	-20-40°C	-20-40°C	-20-40°C	-20-40°C
空载转速 No-load Speed	Rpm	235	235	215	215	185	185
空载电流 No-load Current	A	4	4	4	4	4	4
额定负载 Nominal Torque	N.m	21	21	30	30	30	30
额定转速 Nominal Speed	Rpm	180	180	180	180	150	150
额定电流 Nominal Current	A	25	25	30	30	30	30
工作制 Duty Cycle	S%	S1	S1	S1	S1	S1	S1
出水口 Water Tube	WT		✓		✓	✓	✓
电机转向 Motor Rotation	CW/CCW	CW	CW	CW	CW	CW	CW
安装方式 Installation	Type	键槽 Keyway	螺纹 screw thread	键槽 Keyway	螺纹 screw thread	螺纹 screw thread	螺纹 screw thread
电机噪音 Motor Noise	dBA/1m	<65	<65	<65	<65	<65	<65
电机尺寸 Motor Dimension	L (mm)	243	225	267.5	249.5	270.5	274
	D (mm)	190.5	190.5	190.5	190.5	190.5	190.5
电机重量 Motor Weight	Kg	7.6	6.6	7.6	7.6	7.6	7.6

电机设计 Motor Design							
绝缘等级 Insulation Degree	Class	F	F	F	F	F	F
温控 Thermal Protection	Optional	✓	✓	✓	✓	✓	✓
防水等级 IP Class	Class	IP20	IP20	IP20	IP20	IP20	IP20
励磁方式 Excitation	Wound	永磁 PM	永磁 PM	永磁 PM	永磁 PM	永磁 PM	永磁 PM
振动 Vibration	mm/S	<2	<2	<2	<2	<2	<2
绝缘强度 Insulation Resistance	MΩ	>10	>10	>10	>10	>10	>10
电机寿命 Motor Endurance	Hrs	2000	2000	2000	2000	2000	2000

其他 Other *可更换电机碳刷 Changeable Brushes

BRUSHLESS DC MOTOR

直流无刷电机

一体机
Controller Integrated Motor



• 电机图纸 Motor drawings

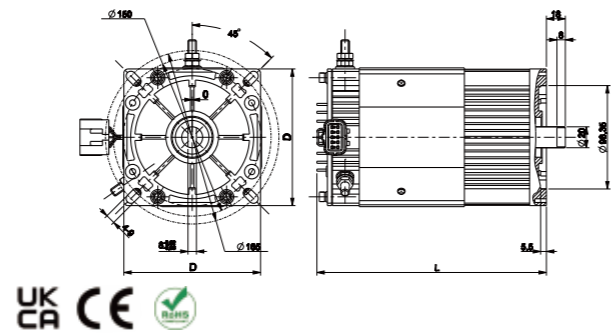

电机参数 Motor Data		电机型号 Motor Model									
		LD014	LD030	LD031	LD017	LD033	LD013	LD032	LD027	LD028	
额定功率 Nominal Power	kW	1.0	1.5	2.0	2.5	3.0	1.2	1.5	2.0	3.0	
额定电压 Nominal Voltage	V	24	24	24	24	24	48	48	48	48	
环境温度 Environmental Temperature	°C	-20~40°C	-20~40°C	-20~40°C	-20~40°C	-20~40°C	-20~40°C	-20~40°C	-20~40°C	-20~40°C	
空载转速 No-load Speed	Rpm	3100	3100	3100	3100	3100	3100	3100	3100	3100	
空载电流 No-load Current	A	6	10	12	15	20	8	10	12	20	
额定负载 Nominal Torque	N.m	3.6	6.0	7.0	10.0	12.0	4.0	6.0	8.0	12.0	
额定转速 Nominal Speed	Rpm	2650	2600	2650	2650	2650	3000	2850	2700	2650	
额定电流 Nominal Current	A	52	75	92	130	165	32	45	46	85	
工作制 Duty Cycle	S2	S1	30MIN	15MIN	15MIN	6MIN	60MIN	60MIN	60MIN	15MIN	
	S3		20%ED	16%ED	16%ED	12%ED	20%ED	20%ED	20%ED	16%ED	
电机转向 Motor Rotation	CW/CCW	CW	CW	CW	CW	CW	CW	CW	CW	CW	
电机噪音 Motor Noise	dBA/1m	68	68	68	68	68	68	68	68	68	
电机尺寸 Motor Dimension	L (mm)	189	189	189	189	189	189	189	189	189	
	D (mm)	130	130	130	130	130	130	130	130	130	
电机重量 Motor Weight	Kg	6.3	6.3	6.3	6.3	6.3	6.3	6.3	6.3	6.3	

电机设计 Motor Design

绝缘等级 Insulation Degree	Class	F	F	F	F	F	F	F	F	F
温控 Thermal Protection	Optional	✓	✓	✓	✓	✓	✓	✓	✓	✓
防水等级 IP Class	Class	IP65	IP65	IP65	IP65	IP65	IP65	IP65	IP65	IP65
励磁方式 Excitation	Wound	永磁 PM	永磁 PM	永磁 PM	永磁 PM	永磁 PM	永磁 PM	永磁 PM	永磁 PM	永磁 PM
振动 Vibration	mm/S	<2	<2	<2	<2	<2	<2	<2	<2	<2
绝缘强度 Insulation Resistance	MΩ	>20	>20	>20	>20	>20	>20	>20	>20	>20
电机寿命 Motor Endurance	Hrs									

其他 Other *可更换电机碳刷 Changeable Brushes

DC BRUSHED MOTOR

直流有刷电机

继电器-开关系列
Solenoid-Switch Family



• 开关图纸 Drawings

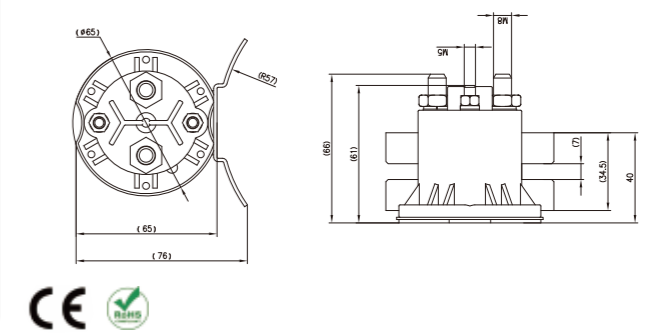

电机参数 Motor Data		电机型号 Motor Model							
		ZJWP100A-12V	ZJWP400A-24V	CZ1-C2-12V	CZ1-C2-24V	ARD1353-12V	ARD1353-24V	SW390-12LL-12V	
开关工作时间(INT) Switch working time (INT)		最大持续占空比 25%/最大工作时间6分钟 MaxS3-25%/Max S2-6min Maximum continuous duty cycle 25%/maximum working time 6 minutes MaxS3-25%/Max S2-6min							
吸合电压(VDC)≤60%V Pull in voltage (VDC) ≤ 60% V	V	≤8.4	≤16.8	≤8.4	≤16.8	≤8.4	≤16.8	≤7	
释放电压 (Release Voltage)5%-40%V	V	0.6-4.8	1.2-9.6	0.6-4.8	1.2-9.6	0.6-4.8	1.2-9.6	0.6-3.5	
开关电阻±8% Switching resistance ± 8%	Ω	4.5	15	5.2	22	4.4	21	4	
额定电流 Rated current	A	100	400	150	150	150	150	150	
瞬时最大电流 Instantaneous maximum current	A	400	1500	800	800	800	800	400	
循环寿命 cycle life	次数 Cycle	300000	300000	300000	300000	100000	100000	50000	
连接材料 Connecting materials	触点 Alloy	银合金 Silver Alloy	银合金 Silver Alloy	铜触点 Cooper Alloy	铜触点 Cooper Alloy	铜触点 Cooper Alloy	铜触点 Cooper Alloy	铜触点 Cooper Alloy	

机械参数 Mechanical parameters

M5 接线螺母 M5 Connection Nut	N.M	/	/	1.7-2	1.7-2	/	/	1.7-2
M8 接线螺母 M8 Connection Nut	N.M	4.5-5.5	/	4.5-5.5	4.5-5.5	15	15	9.8-14
M10接线螺母 M10 Connection Nut	N.M	/	≤10	/	/	/	/	/
安装支架 Mounting Bracket		N型, 弧型 Curved		弧型, 直板型, V型, T型 Curved, Flat		弧型, 直板型, V型, T型 Curved, Flat		N型, 弧型 Curved

环境参数 Environmental parameters

储存和运输温度范围 Storage and transport temperature range	C	-40 C-85 C	-40 C-85 C	-40 C-85 C	-40 C-85 C	-40 C-85 C	-40 C-85 C	-40 C-85 C
工作温度范围 Operating temperature range	C	-40 C-60 C	-40 C-60 C	-40 C-60 C	-40 C-60 C	-40 C-60 C	-40 C-60 C	-40 C-60 C
防护等级 Ingress Protection	Class	IP65	IP65	IP67	IP67	IP54	IP54	IP54

THREE PHASE INDUCTION MOTOR

三相感应电动机

AC平衡重驱动电机

Counter Balance Drive Motor



电机图纸

Motor drawings

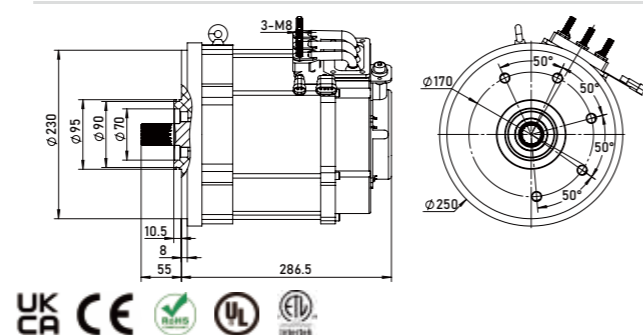

电机参数 Motor Data		电机型号 Motor Model			
		LF015	LF048	LF055	LF043
额定功率 Nominal Power	kW	6	10	16.6	2.2
额定电压 Nominal Voltage	V(AC)	32	55	53	50
额定电流 Nominal Current	A	130	141	236	42
频率 Frequency	HZ	50	101	50	107.5
额定转速 Nominal Speed	RPM	1496	2992	1476	3171
效率 Rated efficiency	n%	0.85	90	91	84
功率因数 Factor	cosφ	0.85	0.82	0.84	0.72
额定转矩 Nominal Torque	N.m	40.7	31.9	107	6.6

电机设计 Motor Design					
工作制 Duty Cycle	Min	60	60	60	60
绝缘等级 Insulation Class	Class	F/H	F/H	F/H	F/H
防护等级 IP Class	Class	IP20/IP44/IP54/IP56/IP66			
电机噪音 Motor Noise	dBA/1m	60	60	60	60
温控 Thermal Protection	Optional	√	√	√	√
绝缘强度 Insulation Resistance	MΩ	≥50	≥50	≥50	≥50

其他 Other *轴按客户要求定制

THREE PHASE INDUCTION MOTOR

三相感应电动机

AC平衡重泵电机

Counter Balance Pump Motor



电机图纸

Motor drawings

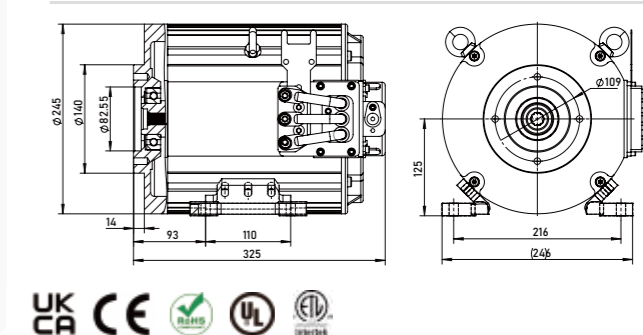

电机参数 Motor Data		电机型号 Motor Model		
		LF033	LF044	LF048
额定功率 Nominal Power	kW	26	7	16
额定电压 Nominal Voltage	V(AC)	50	50	55
额定电流 Nominal Current	A	373	112	212
频率 Frequency	HZ	84.7	85	75
额定转速 Nominal Speed	RPM	2462	2401	2190
效率 Rated efficiency	n%	91.5	84	90.5
功率因数 Factor	cosφ	0.88	0.86	0.86
额定转矩 Nominal Torque	N.m	100	27.8	69.6

电机设计 Motor Design					
工作制 Duty Cycle	Min	60	60	60	60
绝缘等级 Insulation Class	Class	F/H	F/H	F/H	F/H
防护等级 IP Class	Class	IP20/IP44/IP54/IP56/IP66			
电机噪音 Motor Noise	dBA/1m	60	60	60	60
温控 Thermal Protection	Optional	√	√	√	√
绝缘强度 Insulation Resistance	MΩ	≥50	≥50	≥50	≥50

其他 Other *轴按客户要求定制

AC ASYNCHRONOUS MOTOR

交流异步电动机

CDBD-普通铝壳电机B34

Aluminium-Cased Motor B34



• 电机图纸

Motor drawings

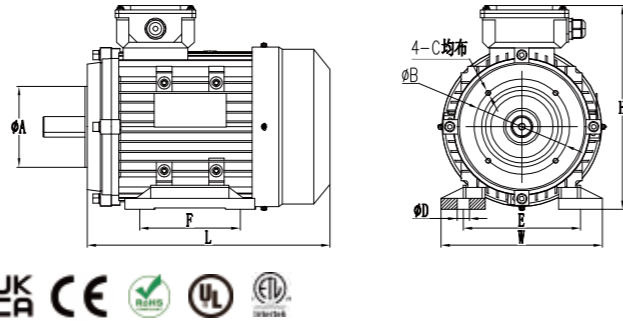

电机参数 Motor Data		电机型号 Motor Model											
		LV509	LV510	LV511	LV512	LV513	LV514	LV515	LV516	LV517	LV518	LV519	LV520
额定功率 Nominal Power	W	750	750	1100	1100	1500	1500	2200	2200	3000	3000	4000	4000
额定电压 Nominal Voltage	V	230/400	230/400	230/400	230/400	230/400	230/400	230/400	230/400	230/400	230/400	230/400	230/400
额定电流 Nominal Current	A	2.9/1.7	3.4/2	4.3/2.5	4.6/2.7	5.7/3.3	6/3.5	8/4.6	8.3/4.8	10.5/6	11.3/6.5	13/7.8	14.5/8.4
频率 Frequency	HZ	50	50	50	50	50	50	50	50	50	50	50	50
额定转速 Nominal Speed	RPM	2800	1400	2800	1400	2800	1400	2800	1400	2800	1400	2800	1400
效率 Rated efficiency	n%	76.5	75.5	77	78	78.5	79	81	81	82.6	82.6	85.5	84.5
功率因数 Factor	cosφ	0.85	0.75	0.85	0.78	0.85	0.79	0.86	0.82	0.87	0.81	0.87	0.82
额定转矩 Nominal Torque	N.m	2.5	5.1	3.7	7.3	5.1	10.2	7.4	14.9	10.1	20.3	13	26.1
Tst/Tn		2.2	2.3	2.2	2.3	2.2	2.3	2	2.2	2.2	2.2	2.2	2.2
Tmax/Tn		2.3	2.4	2.3	2.4	2.3	2.4	2.3	2.3	2.3	2.3	2.3	2.3
Ist/In		6	6	7	6.5	7	6.5	7	7	7	7	7	7

电机设计 Motor Design

工作制 Duty	S1												
绝缘等级 Insulation Class	Class F/H												
防护等级 IP Class	Class IP54/IP55/IP56												
电机尺寸 Motor Dimension	L(mm)	245	245	245	257	257	282	282	325	325	325	345	345
	W(mm)	158	158	158	175	175	175	175	200	200	200	220	220
	H(mm)	200	200	200	220	220	220	220	258	258	258	281	281
安装尺寸 Installation Dimensions	A(mm)	80	80	80	95	95	95	95	110	110	110	110	110
	B(mm)	100	100	100	115	115	115	115	130	130	130	130	130
	C	M6	M6	M6	M8	M8	M8	M8	M8	M8	M8	M8	M8
	D(mm)	10	10	10	10	10	10	10	12	12	12	12	12
	E(mm)	125	125	125	140	140	140	140	160	160	160	190	190
	F(mm)	100	100	100	100	100	125	125	140	140	140	140	140

其他 Other *可定制任意通用电压和频率 Any universal voltage and frequency can be customized
 *能够承受短时间过载 Able to withstand short-term overloads
 *封闭轴承 Closed bearings
 *接线盒旋转4°90° The junction box rotates 4°90°
 *可拆卸式电机底脚 Detachable motor feet
 *海拔高度<1000米 The altitude < 1000 meters above sea level

AC ASYNCHRONOUS MOTOR

交流异步电动机

CEBE-普通铝壳电机B35

Aluminium-Cased Motor B35



• 电机图纸

Motor drawings

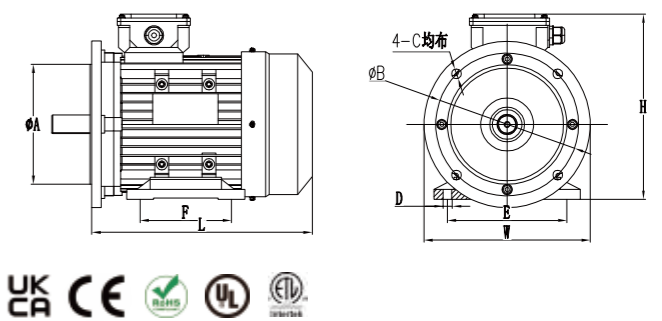

电机参数 Motor Data		电机型号 Motor Model											
		LV509	LV510	LV511	LV512	LV513	LV514	LV515	LV516	LV517	LV518	LV519	LV520
额定功率 Nominal Power	W	750	750	1100	1100	1500	1500	2200	2200	3000	3000	4000	4000
额定电压 Nominal Voltage	V	230/400	230/400	230/400	230/400	230/400	230/400	230/400	230/400	230/400	230/400	230/400	230/400
额定电流 Nominal Current	A	2.9/1.7	3.4/2	4.3/2.5	4.6/2.7	5.7/3.3	6/3.5	8/4.6	8.3/4.8	10.5/6	11.3/6.5	13/7.8	14.5/8.4
频率 Frequency	HZ	50	50	50	50	50	50	50	50	50	50	50	50
额定转速 Nominal Speed	RPM	2800	1400	2800	1400	2800	1400	2800	1400	2800	1400	2800	1400
效率 Rated efficiency	n%	76.5	75.5	77	78	78.5	79	81	81	82.6	82.6	85.5	84.5
功率因数 Factor	cosφ	0.85	0.75	0.85	0.78	0.85	0.79	0.86	0.82	0.87	0.81	0.87	0.82
额定转矩 Nominal Torque	N.m	2.5	5.1	3.7	7.3	5.1	10.2	7.4	14.9	10.1	20.3	13	26.1
Tst/Tn		2.2	2.3	2.2	2.3	2.2	2.3	2	2.2	2.2	2.2	2.2	2.2
Tmax/Tn		2.3	2.4	2.3	2.4	2.3	2.4	2.3	2.3	2.3	2.3	2.3	2.3
Ist/In		6	6	7	6.5	7	6.5	7	7	7	7	7	7

电机设计 Motor Design

工作制 Duty	S1												
绝缘等级 Insulation Class	Class F/H												
防护等级 IP Class	Class IP54/IP55/IP56												
电机尺寸 Motor Dimension	L(mm)	245	245	245	257	257	282	282	325	325	325	345	345
	W(mm)	200	200	200	200	200	200	200	250	250	250	250	250
	H(mm)	200	200	200	220	220	220	220	258	258	258	281	281
安装尺寸 Installation Dimensions	A(mm)	80	80	80	95	95	95	95	110	110	110	110	110
	B(mm)	100	100	100	115	115	115	115	130	130	130	130	130
	C	Φ12	Φ12	Φ12	Φ12	Φ12	Φ12	Φ12	Φ15	Φ15	Φ15	Φ15	Φ15
	D(mm)	10	10	10	10	10	10	10	12	12	12	12	12
	E(mm)	125	125	125	140	140	140	140	160	160	160	190	190
	F(mm)	100	100	100	100	100	125	125	140	140	140	140	140

其他 Other *可定制任意通用电压和频率 Any universal voltage and frequency can be customized
 *能够承受短时间过载 Able to withstand short-term overloads
 *封闭轴承 Closed bearings
 *接线盒旋转4°90° The junction box rotates 4°90°
 *可拆卸式电机底脚 Detachable motor feet
 *海拔高度<1000米 The altitude < 1000 meters above sea level

AC ASYNCHRONOUS MOTOR

交流异步电动机

EHBD-高效IE3铝壳电机B34

IE3 Aluminium-Cased Motor B34



• 电机图纸

Motor drawings

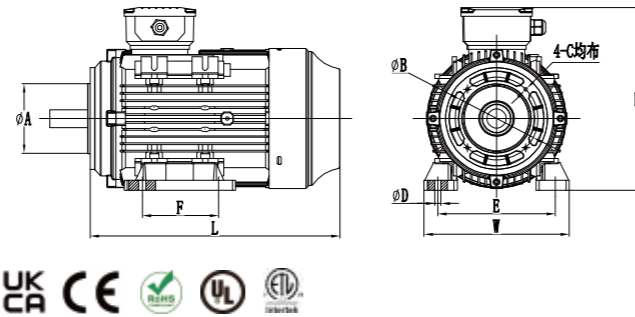

电机参数 Motor Data		电机型号 Motor Model															
		LV709	LV710	LV711	LV712	LV713	LV714	LV715	LV716	LV717	LV718	LV719	LV720	LV721	LV722	LV723	LV724
额定功率 Nominal Power	W	750	750	1100	1100	1500	1500	2200	2200	3000	3000	4000	4000	5500	5500	7500	7500
额定电压 Nominal Voltage	V	400	400	400	400	400	400	400	400	400	400	400	400	400	400	400	400
额定电流 Nominal Current	A	1.6	1.8	2.3	2.5	3.1	3.4	4.4	4.5	5.7	6	7.4	8	10.1	10.8	13.5	14.4
频率 Frequency	HZ	50	50	50	50	50	50	50	50	50	50	50	50	50	50	50	50
额定转速 Nominal Speed	RPM	2805	1410	2840	1435	2855	1430	2845	1450	2880	1450	2895	1450	2920	1455	2915	1455
效率 Rated efficiency	n%	80.7	82.5	82.7	84.1	84.2	85.3	85.9	86.7	87.1	87.7	88.1	88.6	89.2	89.6	90.1	90.4
功率因数 Factor	cosφ	0.83	0.75	0.83	0.75	0.84	0.75	0.85	0.81	0.87	0.82	0.88	0.82	0.88	0.82	0.89	0.83
额定转矩 Nominal Torque	N.m	2.55	5.1	3.7	7.3	5.02	10	7.38	14.5	9.95	19.8	13.2	26.3	18	36.1	24.6	49.2
Tst/Tn		2.3	2.3	2.3	2.3	2.3	2.3	2.3	2.3	2.3	2.3	2.3	2.3	2.2	2	2.2	2
Tmax/Tn		2.3	2.3	2.3	2.3	2.3	2.3	2.3	2.3	2.3	2.3	2.3	2.3	2.3	2.3	2.3	2.3
Ist/In		6.8	6.5	7.3	6.6	7.6	6.9	7.8	7.5	8.1	7.6	8.3	7.7	8	7.5	7.8	7.4

电机设计 Motor Design

工作制 Duty	S1																
绝缘等级 Insulation Class	Class F/H																
防护等级 IP Class	Class IP54/IP55/IP56																
电机尺寸 Motor Dimension	L(mm)	287	287	287	317	317	342	342	391	391	391	391	391	426	426	426	454
	W(mm)	158	158	158	175	175	175	175	200	200	200	225	225	255	255	255	255
	H(mm)	210	210	210	225	225	225	225	265	265	265	290	290	330	330	330	330
安装尺寸 Installation Dimensions	A(mm)	80	80	80	95	95	95	95	110	110	110	110	110	130	130	130	130
	B(mm)	100	100	100	115	115	115	115	130	130	130	130	130	165	165	165	165
	C	M6	M6	M6	M8	M8	M8	M8	M8	M8	M8	M8	M8	M10	M10	M10	M10
	D(mm)	10	10	10	10	10	10	10	12	12	12	12	12	13	13	13	13
	E(mm)	125	125	125	140	140	140	140	160	160	160	190	190	216	216	216	216
	F(mm)	100	100	100	100	100	125	125	140	140	140	140	140	140	140	140	178

其他 Other *可定制任意通用电压和频率 Any universal voltage and frequency can be customized
 *能够承受短时间过载 Able to withstand short-term overloads
 *封闭轴承 Closed bearings
 *接线盒旋转4°90° The junction box rotates 4°90°
 *可拆卸式电机底脚 Detachable motor feet
 *海拔高度<1000米 The altitude < 1000 meters above sea level

AC ASYNCHRONOUS MOTOR

交流异步电动机

EIBE-高效IE3铝壳电机B35

IE3 Aluminium-Cased Motor B35



• 电机图纸

Motor drawings

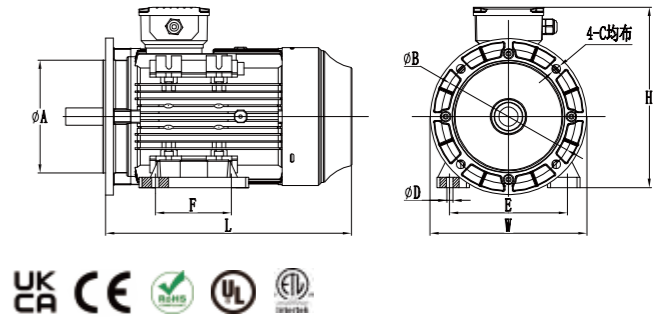

电机参数 Motor Data		电机型号 Motor Model															
		LV709	LV710	LV711	LV712	LV713	LV714	LV715	LV716	LV717	LV718	LV719	LV720	LV721	LV722	LV723	LV724
额定功率 Nominal Power	W	750	750	1100	1100	1500	1500	2200	2200	3000	3000	4000	4000	5500	5500	7500	7500
额定电压 Nominal Voltage	V	400	400	400	400	400	400	400	400	400	400	400	400	400	400	400	400
额定电流 Nominal Current	A	1.6	1.8	2.3	2.5	3.1	3.4	4.4	4.5	5.7	6	7.4	8	10.1	10.8	13.5	14.4
频率 Frequency	HZ	50	50	50	50	50	50	50	50	50	50	50	50	50	50	50	50
额定转速 Nominal Speed	RPM	2805	1410	2840	1435	2855	1430	2845	1450	2880	1450	2895	1450	2920	1455	2915	1455
效率 Rated efficiency	n%	80.7	82.5	82.7	84.1	84.2	85.3	85.9	86.7	87.1	87.7	88.1	88.6	89.2	89.6	90.1	90.4
功率因数 Factor	cosφ	0.83	0.75	0.83	0.75	0.84	0.75	0.85	0.81	0.87	0.82	0.88	0.82	0.88	0.82	0.89	0.83
额定转矩 Nominal Torque	N.m	2.55	5.1	3.7	7.3	5.02	10	7.38	14.5	9.95	19.8	13.2	26.3	18	36.1	24.6	49.2
Tst/Tn		2.3	2.3	2.3	2.3	2.3	2.3	2.3	2.3	2.3	2.3	2.3	2.3	2.2	2	2.2	2
Tmax/Tn		2.3	2.3	2.3	2.3	2.3	2.3	2.3	2.3	2.3	2.3	2.3	2.3	2.3	2.3	2.3	2.3
Ist/In		6.8	6.5	7.3	6.6	7.6	6.9	7.8	7.5	8.1	7.6	8.3	7.7	8	7.5	7.8	7.4

电机设计 Motor Design

工作制 Duty	S1																
绝缘等级 Insulation Class	Class F/H																
防护等级 IP Class	Class IP54/IP55/IP56																
电机尺寸 Motor Dimension	L(mm)	287	287	287	317	317	342	342	391	391	391	391	391	426	426	426	454
	W(mm)	200	200	200	200	200	200	200	250	250	250	250	250	300	300	300	300
	H(mm)	210	210	210	225	225	225	225	265	265	265	290	290	330	330	330	330
安装尺寸 Installation Dimensions	A(mm)	80	80	80	95	95	95	95	110	110	110	110	110	130	130	130	130
	B(mm)	100	100	100	115	115	115	115	130	130	130	130	130	165	165	165	165
	C	Φ10	Φ10	Φ10	Φ10	Φ10	Φ10	Φ10	Φ12	Φ12	Φ12	Φ12	Φ12	Φ15	Φ15	Φ15	Φ15
	D(mm)	10	10	10	10	10	10	10	12	12	12	12	12	13	13	13	13
	E(mm)	125	125	125	140	140	140	140	160	160	160	190	190	216	216	216	216
	F(mm)	100	100	100	100	100	125	125	140	140	140	140	140	140	140	140	178

其他 Other *可定制任意通用电压和频率 Any universal voltage and frequency can be customized
 *能够承受短时间过载 Able to withstand short-term overloads
 *封闭轴承 Closed bearings
 *接线盒旋转4°90° The junction box rotates 4°90°
 *可拆卸式电机底脚 Detachable motor feet
 *海拔高度<1000米 The altitude < 1000 meters above sea level

AC ASYNCHRONOUS MOTOR

交流异步电动机

CBBB-液压动力单元电机

Hydraulic Power-Pack Motor



电机图纸

Motor drawings

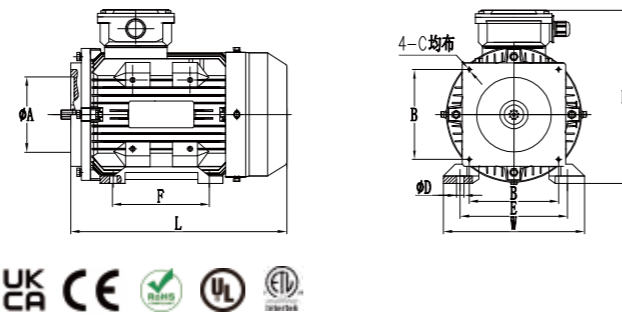

电机参数 Motor Data		电机型号 Motor Model											
		LV507	LV508	LV509	LV510	LV511	LV512	LV513	LV514	LV515	LV516	LV517	LV518
额定功率 Nominal Power	W	550	550	750	750	1100	1100	1500	1500	2200	2200	3000	3000
额定电压 Nominal Voltage	V	400	400	400	400	400	400	400	400	400	400	400	400
额定电流 Nominal Current	A	1.3	1.4	1.7	1.7	2.4	2.6	3.1	3.3	4.5	4.8	6.3	6.6
频率 Frequency	HZ	50	50	50	50	50	50	50	50	50	50	50	50
额定转速 Nominal Speed	RPM	2828	1400	2828	1400	2828	1400	2840	1410	2840	1410	2840	1410
效率 Rated efficiency	n%	72	72	75	75	75	75	80	80	83	80	82	81
功率因数 Factor	cosφ	0.86	0.8	0.83	0.84	0.88	0.84	0.88	0.83	0.85	0.82	0.84	0.81
额定转矩 Nominal Torque	N.m	1.9	3.8	2.5	5.2	3.7	7.7	5.1	10.2	7.4	15	10.1	20.3
Tst/Tn		1.6	2	1.8	2	2	1.8	1.8	2	2.2	2.2	2	2.2
Tmax/Tn		2.1	2.2	2.3	2.2	2.2	2	2	2.2	2.5	3	2.5	2.5
Ist/In		4.2	4	5	4.2	5	4.5	5.5	6	6.5	5	7	5

电机设计 Motor Design

工作制 Duty		S2/S3											
绝缘等级 Insulation Class		B/F/H											
防护等级 IP Class		IP54/IP55											
电机尺寸 Motor Dimension	L(mm)	260	260	260	260	260	260	260	260	284	284	284	320
	W(mm)	158	158	158	158	158	158	175	175	175	175	175	200
	H(mm)	200	200	200	200	200	200	220	220	220	220	220	258
安装尺寸 Installation Dimensions	A(mm)	Φ98.3/Φ110											
	B*B(mm)	113*113/117*117											
	C	M6/Φ7/Φ9											
	D(mm)	10	10	10	10	10	10	10	10	10	10	10	12
	E(mm)	125	125	125	125	125	125	140	140	140	140	140	160
	F(mm)	100	100	100	100	100	100	100	100	100	125	125	125

其他 Other *可定制客户端轴连接方式 The connection mode of the client axis can be customized *接线盒旋转4°90° The junction box rotates 4°90°
 *可定制任意通用电压和频率 Any universal voltage and frequency can be customized *可拆卸式电机底脚 Detachable motor feet
 *封闭轴承 Closed bearings *海拔高度<1000米 The altitude < 1000 meters above sea level

AC ASYNCHRONOUS MOTOR

交流异步电动机

CLBD-举升机电机

Car Lift Motor



电机图纸

Motor drawings

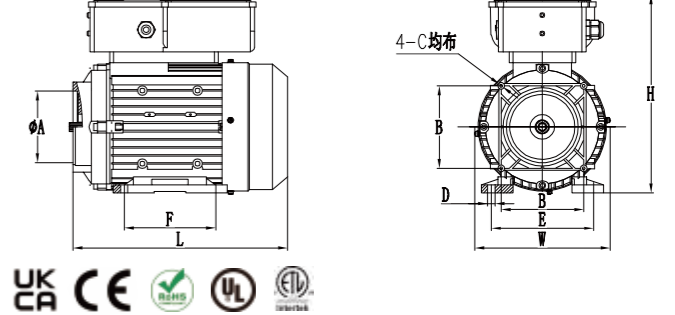

电机参数 Motor Data		电机型号 Motor Model	
		LV515	LV215
额定功率 Nominal Power	W	2200	2200
额定电压 Nominal Voltage	V	三相230/400	单相220-230
额定电流 Nominal Current	A	5.2	13
频率 Frequency	HZ	50	50
额定转速 Nominal Speed	RPM	2840	2890
效率 Rated efficiency	n%	78.5	81
功率因数 Factor	cosφ	0.82	0.95
额定转矩 Nominal Torque	N.m	7.4	7.26
Tst/Tn		3.3	2.5
Tmax/Tn		3.3	2.5
Ist/In		7.1	5.3

电机设计 Motor Design

工作制 Duty		S2/S3	
绝缘等级 Insulation Class		B/F	
防护等级 IP Class		IP54	
电机尺寸 Motor Dimension	L(mm)	292	300
	W(mm)	175	176
	H(mm)	270	275
安装尺寸 Installation Dimensions	A(mm)	Φ98.3	
	B*B(mm)	113*113	
	C	M6/Φ7	
	D(mm)	10	
	E(mm)	140	
	F(mm)	125	

其他 Other *可定制任意通用电压和频率 Any universal voltage and frequency can be customized *按钮开关 Push button switch
 *能够承受短时间过载 Able to withstand short-term overloads *可拆卸式电机底脚 Detachable motor feet
 *封闭轴承 Closed bearings *海拔高度<1000米 The altitude < 1000 meters above sea level

AC ASYNCHRONOUS MOTOR

交流异步电动机

CBAB-登车桥三相电机

Three Phase Dock Leveller Motor



电机图纸 Motor drawings

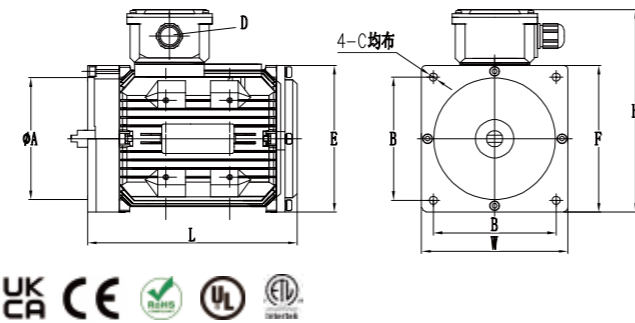

电机参数 Motor Data		电机型号 Motor Model											
		LV509				LV511				LV513			
额定功率 Nominal Power	W	750				1100				1500			
额定电压 Nominal Voltage	V	220	380	230	400	220	380	230	400	220	380	230	400
额定电流 Nominal Current	A	3.6	2.1	3.3	1.9	4.7	2.7	4.5	2.6	6.4	3.7	5.9	3.4
频率 Frequency	HZ	50				50				50			
额定转速 Nominal Speed	RPM	2850	2850	2860	2860	2750	2750	2780	2780	2650	2650	2750	2750
效率 Rated efficiency	n%	78	78	75	75	76	76	73.5	73.5	72	72	74	74
功率因数 Factor	cosφ	0.68	0.68	0.7	0.7	0.81	0.81	0.81	0.81	0.85	0.85	0.85	0.85
额定转矩 Nominal Torque	N.m	2.51	2.51	2.51	2.51	3.8	3.8	3.8	3.8	5.42	5.42	5.4	5.4
Tst/Tn		3.3	3.3	2.46	2.46	2.35	2.35	2.35	2.35	2.1	2.1	2.7	2.7
Tmax/Tn		3.6	3.6	2.67	2.67	2.51	2.51	2.51	2.51	2.2	2.2	2.85	2.85
Ist/In		6.1	6.1	4.9	4.9	4.6	4.6	4.6	4.6	4	4	4.75	4.75

电机设计 Motor Design

工作制 Duty		S2/S3			
绝缘等级 Insulation Class	Class	B/F			
防护等级 IP Class	Class	IP54/IP55/IP56			
电机尺寸 Motor Dimension	L(mm)	186			
	W(mm)	132/133			
	H(mm)	180			
安装尺寸 Installation Dimensions	A(mm)	Φ98.3/Φ110			
	B*B(mm)	113*113/117*117			
	C	M6/Φ7/Φ9			
	D	M18*1.5/PG13.5/PG11			
	E(mm)	132			
	F(mm)	132/133			

其他 Other *可定制客户端轴连接方式 The connection mode of the client axis can be customized *接线盒旋转4°90° The junction box rotates 4°90°
 *可定制任意通用电压和频率 Any universal voltage and frequency can be customized *可定制长引线 Long leads can be customized
 *封闭轴承 Closed bearings *海拔高度<1000米 The altitude < 1000 meters above sea level

AC ASYNCHRONOUS MOTOR

交流异步电动机

CCAB-登车桥三相电机轴承外露式

Three Phase Dock Leveller-Exposed Bearing Motor



电机图纸 Motor drawings

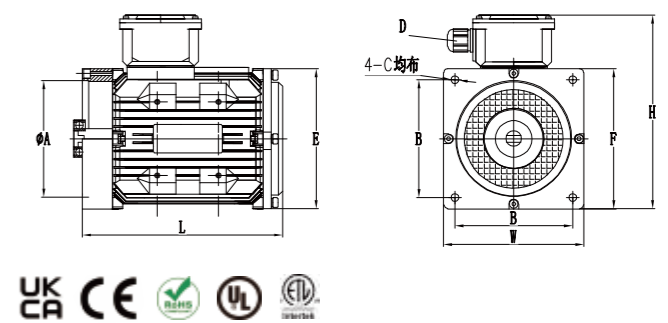

电机参数 Motor Data		电机型号 Motor Model											
		LV509				LV511				LV513			
额定功率 Nominal Power	W	750				1100				1500			
额定电压 Nominal Voltage	V	220	380	230	400	220	380	230	400	220	380	230	400
额定电流 Nominal Current	A	3.6	2.1	3.3	1.9	4.7	2.7	4.5	2.6	6.4	3.7	5.9	3.4
频率 Frequency	HZ	50				50				50			
额定转速 Nominal Speed	RPM	2850	2850	2860	2860	2750	2750	2780	2780	2650	2650	2750	2750
效率 Rated efficiency	n%	78	78	75	75	76	76	73.5	73.5	72	72	74	74
功率因数 Factor	cosφ	0.68	0.68	0.7	0.7	0.81	0.81	0.81	0.81	0.85	0.85	0.85	0.85
额定转矩 Nominal Torque	N.m	2.51	2.51	2.51	2.51	3.8	3.8	3.8	3.8	5.42	5.42	5.4	5.4
Tst/Tn		3.3	3.3	2.46	2.46	2.35	2.35	2.35	2.35	2.1	2.1	2.7	2.7
Tmax/Tn		3.6	3.6	2.67	2.67	2.51	2.51	2.51	2.51	2.2	2.2	2.85	2.85
Ist/In		6.1	6.1	4.9	4.9	4.6	4.6	4.6	4.6	4	4	4.75	4.75

电机设计 Motor Design

工作制 Duty		S2/S3			
绝缘等级 Insulation Class	Class	B/F			
防护等级 IP Class	Class	IP54/IP55/IP56			
电机尺寸 Motor Dimension	L(mm)	186			
	W(mm)	132/133			
	H(mm)	180			
安装尺寸 Installation Dimensions	A(mm)	Φ98.3/Φ110			
	B*B(mm)	113*113/117*117			
	C	M6/Φ7/Φ9			
	D	M18*1.5/PG13.5/PG11			
	E(mm)	132			
	F(mm)	132/133			

其他 Other *可定制客户端轴连接方式 The connection mode of the client axis can be customized *接线盒旋转4°90° The junction box rotates 4°90°
 *可定制任意通用电压和频率 Any universal voltage and frequency can be customized *可定制长引线 Long leads can be customized
 *封闭轴承 Closed bearings *海拔高度<1000米 The altitude < 1000 meters above sea level

AC ASYNCHRONOUS MOTOR

交流异步电动机

CBAB-登车桥单相电机

Single-Phase Dock Leveller Motor



电机图纸

Motor drawings

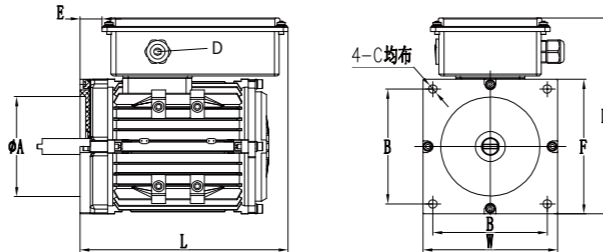

电机参数 Motor Data		电机型号 Motor Model			
		LV209			
额定功率 Nominal Power	W	750			
额定电压 Nominal Voltage	V	115	115	230	230
额定电流 Nominal Current	A	9.3	8.5	4.8	6.5
频率 Frequency	HZ	50	60	50	60
额定转速 Nominal Speed	RPM	2880	3470	2885	3480
效率 Rated efficiency	n%	78	80	72.3	67.5
功率因数 Factor	cosφ	0.89	0.99	0.94	0.75
额定转矩 Nominal Torque	N.m	2.5	2.1	2.5	2
Tst/Tn		1.8	1.8	1.8	1.8
Tmax/Tn		2.5	2.5	2.5	2.5
Ist/In		6.5	6.5	6.5	6.5

电机设计 Motor Design

工作制 Duty		S2/S3
绝缘等级 Insulation Class	Class	B/F
防护等级 IP Class	Class	IP54/IP55
电机尺寸 Motor Dimension	L(mm)	205
	W(mm)	132/133
	H(mm)	193
安装尺寸 Installation Dimensions	A(mm)	Φ98.3/Φ110
	B*B(mm)	113*113/117*117
	C	M6/Φ7/Φ9
	D(mm)	M18*1.5/PG13.5/PG11
	E(mm)	20
	F(mm)	132/133

其他 Other *可定制客户端轴连接方式 The connection mode of the client axis can be customized *铁质接线盒 Iron junction box
 *电子离心开关 Electronic centrifugal switch *可定制长引线 Long leads can be customized
 *封闭轴承 Closed bearings *海拔高度<1000米 The altitude < 1000 meters above sea level

AC ASYNCHRONOUS MOTOR

交流异步电动机

AJAB-油浸式电机A款

Sub-Oil Motor



电机图纸

Motor drawings

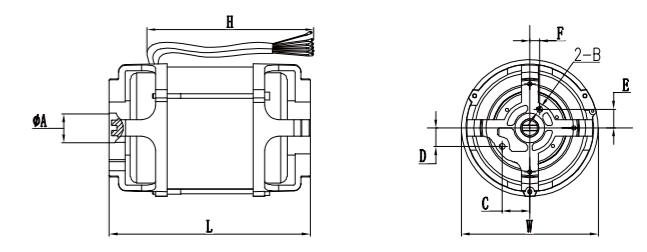

电机参数 Motor Data		电机型号 Motor Model					
		LV808	LV810	LV812	LV814	LV816	LV818
额定功率 Nominal Power	W	550	750	1100	1500	2200	3000
额定电压 Nominal Voltage	V	230/400	230/400	230/400	230/400	230/400	230/400
额定电流 Nominal Current	A	2.4/1.4	3.1/1.8	4.3/2.5	5.9/3.4	8.9/5.1	12.1/7.0
频率 Frequency	HZ	50	50	50	50	50	50
额定转速 Nominal Speed	RPM	1362	1383	1390	1371	1344	1322
效率 Rated efficiency	n%	70	73	76	75	74	73
功率因数 Factor	cosφ	0.81	0.83	0.84	0.85	0.84	0.85
额定转矩 Nominal Torque	N.m	3.9	5.2	7.6	10.5	15.6	21.7
Tst/Tn		1.9	2	2	2	1.8	1.6
Tmax/Tn		1.9	2.1	2	2.2	2.1	2
Ist/In		3.5	4.2	4.7	4.3	3.8	3.9

电机设计 Motor Design

工作制 Duty		S3-10%/S3-15%/S3-20%/S3-30%					
绝缘等级 Insulation Class	Class	B/F					
防护等级 IP Class	Class	IP00					
电机尺寸 Motor Dimension	L(mm)	158	168	190	200	215	235
	W(mm)	146.5	146.5	146.5	146.5	146.5	146.5
	H(mm)	350	350	350	350	350	350
安装尺寸 Installation Dimensions	A(mm)	Φ32	Φ32	Φ32	Φ32	Φ32	Φ32
	B	M8	M8	M8	M8	M8	M8
	C(mm)	29.7	29.7	29.7	29.7	29.7	29.7
	D(mm)	20	20	20	20	20	20
	E(mm)	20	20	20	20	20	20
	F(mm)	10.3	10.3	10.3	10.3	10.3	10.3

其他 Other *可定制任意通用电压和频率 Any universal voltage and frequency can be customized *可卧式安装 Can be installed horizontally
 *可定制客户端轴连接方式 The connection mode of the client axis can be customized *可配接线板 Patch strips are available
 *耐油耐高温引线 Oil-resistant and high-temperature resistant lead wires *海拔高度<1000米 The altitude < 1000 meters above sea level

AC ASYNCHRONOUS MOTOR

交流异步电动机

AKAB-油浸式电机B款

Sub-Oil Motor



• 电机图纸

Motor drawings

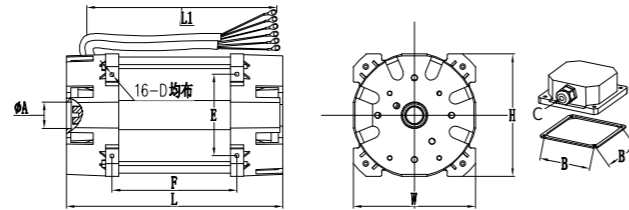

电机参数 Motor Data		电机型号 Motor Model					
		LV812	LV814	LV816	LV818	LV820	LV822
额定功率 Nominal Power	W	1100	1500	2200	3000	4000	5500
额定电压 Nominal Voltage	V	230/400	230/400	230/400	230/400	230/400	230/400
额定电流 Nominal Current	A	4.7/2.7	6.1/3.5	9.1/5.2	12.9/7.3	16.8/9.6	22.7/13.1
频率 Frequency	HZ	50	50	50	50	50	50
额定转速 Nominal Speed	RPM	1379	1391	1365	1351	1353	1319
效率 Rated efficiency	n%	71	75	74	72	73	71
功率因数 Factor	cosφ	0.82	0.82	0.82	0.82	0.82	0.81
额定转矩 Nominal Torque	N.m	7.6	10.3	15	21.2	28.2	37.6
Tst/Tn		1.1	1.2	1.1	1.1	1.1	1.1
Tmax/Tn		1.6	1.7	1.5	1.4	1.4	1.2
Ist/In		3	3.3	3	3	3	2.6

电机设计 Motor Design

工作制 Duty		S3-10%/S3-15%/S3-20%/S3-30%					
绝缘等级 Insulation Class	Class	B/F	B/F	B/F	B/F	B/F	B/F
防护等级 IP Class	Class	IP00	IP00	IP00	IP00	IP00	IP00
电机尺寸 Motor Dimension	L(mm)	168	183	198	218	243	268
	W*H(mm)	138*138	138*138	138*138	138*138	138*138	138*138
	L1(mm)	1100	1100	1100	1100	1100	1100
安装尺寸 Installation Dimensions	A(mm)	Φ30	Φ30	Φ30	Φ30	Φ30	Φ30
	B*B(mm)	84*84	84*84	84*84	84*84	84*84	84*84
	C	M18*1.5/M20*1.5/PG13.5					
	D	M6	M6	M6	M6	M6	M6
	E(mm)	92	92	92	92	92	92
	F(mm)	65	80	95	115	140	165

其他 Other *可定制任意通用电压和频率 Any universal voltage and frequency can be customized
 *可定制客户端轴连接方式 The connection mode of the client axis can be customized
 *耐油耐高温引接线 Oil-resistant and high-temperature resistant lead wires
 *可卧式安装 Can be installed horizontally
 *可配接线板 Patch strips are available
 *海拔高度<1000米 The altitude < 1000 meters above sea level

AC ASYNCHRONOUS MOTOR

交流异步电动机

FBBB-电动液压推杆电动机

Electro-Hydraulic Actuator Motor



• 电机图纸

Motor drawings

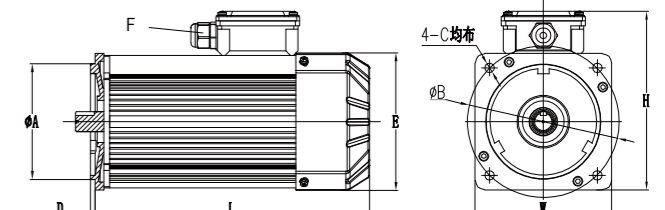

电机参数 Motor Data		电机型号 Motor Model			
		LV511	LV513	LV515	LV517
额定功率 Nominal Power	W	1100	1500	2200	3600
额定电压 Nominal Voltage	V	230/400	230/400	230/400	230/400
额定电流 Nominal Current	A	4.1/2.3	5.6/3.2	8.0/4.6	13.2/7.6
频率 Frequency	HZ	50	50	50	50
额定转速 Nominal Speed	RPM	2842	2822	2810	2788
效率 Rated efficiency	n%	77	77	78	78
功率因数 Factor	cosφ	0.88	0.87	0.89	0.88
额定转矩 Nominal Torque	N.m	3.7	5.1	7.5	12.3
Tst/Tn		2	2	2	2
Tmax/Tn		2.2	2.2	2.1	2.2
Ist/In		5	5	5	5

电机设计 Motor Design

工作制 Duty		S1/S2/S3			
绝缘等级 Insulation Class	Class	B/F/H	B/F/H	B/F/H	B/F/H
防护等级 IP Class	Class	IP54/IP55	IP54/IP55	IP54/IP55	IP54/IP55
电机尺寸 Motor Dimension	L(mm)	237	242	262	287
	W(mm)	130	130	130	130
	H(mm)	170	170	170	170
安装尺寸 Installation Dimensions	A(mm)	110	110	110	110
	B(mm)	145	145	145	145
	C(mm)	Φ9	Φ9	Φ9	Φ9
	D(mm)	4	4	4	4
	E(mm)	130	130	130	130
	F	M20*1.5/PG13.5	M20*1.5/PG13.5	M20*1.5/PG13.5	M20*1.5/PG13.5

其他 Other *可定制客户端轴连接方式 The connection mode of the client axis can be customized
 *可定制任意通用电压和频率 Any universal voltage and frequency can be customized
 *封闭轴承 Closed bearings
 *金属螺套/格兰头 Metal screw sleeves/glands
 *可定制长引线 Long leads can be customized
 *海拔高度<1000米 The altitude < 1000 meters above sea level

客户要求调查问卷 Customer Requests Survey Questionnaire

Customer: 客户:		Application: 应用:	
Customer motor PN: 客户电机PN:		Target market area: 目标市场区域:	
Competitor: 竞争对手:		Standard MENGYANG product for ref: 参考用标准梦阳产品:	
		Replacement or new development: 替代产品或新开发产品:	

额定负载点 Rated Load Point

Voltage: 电压:		VDC	Output power: 输出功率:		Watts hp
Current: 电流:		Amps	Speed: 转速:		RPM
Torque: 扭矩:		N-m ft-lb			
Pump displacement: 泵排量:		cc/rev in ³ /rev			
Oil pressure: 油压:		bar psig	Flowrate: 流量:		L/Min.
Duty cycle: 占空比:		min. S2 %. S3	Expected life: 预期寿命:		cycles hrs

第2负载点 2nd Load Point

Voltage: 电压:		VDC	Output power: 输出功率:		Watts hp
Current: 电流:		Amps	Speed: 转速:		RPM
Torque: 扭矩:		N-m ft-lb			
Oil pressure: 油压:		bar psig	Flowrate: 流量:		L/Min.

第3负载点 3rd Load Point

Voltage: 电压:		VDC	Output power: 输出功率:		Watts hp
Current: 电流:		Amps	Speed: 转速:		RPM
Torque: 扭矩:		N-m ft-lb			
Oil pressure: 油压:		bar psig	Flowrate: 流量:		L/Min.

机械详情 Mechanical Details

IP rating: IP评级:		Vibration requirements: 振动要求:	
Rotation, viewed from output end: 从输出端看的旋转方向:	CW CCW	Noise requirements: 噪音要求:	
Has a mechanical drawings been provided: 是否提供机械图纸:	yes no		

客户要求调查问卷 Customer Requests Survey Questionnaire

Customer: 客户:		Application: 应用:	
Customer motor PN: 客户电机PN:		Target market area: 目标市场区域:	
Competitor: 竞争对手:		Standard MENGYANG product for ref: 参考用标准梦阳产品:	
		Replacement or new development: 替代产品或新开发产品:	

额定负载点 Rated Load Point

Voltage: 电压:		VDC	Output power: 输出功率:		Watts hp
Current: 电流:		Amps	Speed: 转速:		RPM
Torque: 扭矩:		N-m ft-lb			
Pump displacement: 泵排量:		cc/rev in ³ /rev			
Oil pressure: 油压:		bar psig	Flowrate: 流量:		L/Min.
Duty cycle: 占空比:		min. S2 %. S3	Expected life: 预期寿命:		cycles hrs

第2负载点 2nd Load Point

Voltage: 电压:		VDC	Output power: 输出功率:		Watts hp
Current: 电流:		Amps	Speed: 转速:		RPM
Torque: 扭矩:		N-m ft-lb			
Oil pressure: 油压:		bar psig	Flowrate: 流量:		L/Min.

第3负载点 3rd Load Point

Voltage: 电压:		VDC	Output power: 输出功率:		Watts hp
Current: 电流:		Amps	Speed: 转速:		RPM
Torque: 扭矩:		N-m ft-lb			
Oil pressure: 油压:		bar psig	Flowrate: 流量:		L/Min.

机械详情 Mechanical Details

IP rating: IP评级:		Vibration requirements: 振动要求:	
Rotation, viewed from output end: 从输出端看的旋转方向:	CW CCW	Noise requirements: 噪音要求:	
Has a mechanical drawings been provided: 是否提供机械图纸:	yes no		